



Product Change Notification

Change Notification #: 118676-00
Change Title: Select Intel® Wi-Fi 6 AX201 1216,
Intel® Killer™ Wi-Fi 6 AX1650 1216,
PCN 118676-00, Label, Product Marking
Label, and Marking Update
Date of Publication: November 19, 2021

Key Characteristics of the Change:

Label, Product Marking

Forecasted Key Milestones:

| | |
|--|-------------------|
| Date Customer Must be Ready to Receive Post-Conversion Material | December 10, 2021 |
|--|-------------------|

Description of Change to the Customer:

The Intel® Wi-Fi 6 AX201 and Intel® Killer™ Wi-Fi 6 AX1650 1216 SKUs listed in the products affected table below will undergo the following changes.

1. Update Singapore iDA on the Disti Label.
2. Update UK/Brexit table on the Disti Label.
3. Add UKCA logo on the product marking and the Disti Label.
4. The Intel tracking revision will be changed on the following products.

| Product Code | Before | After |
|----------------|--------|-------|
| AX201.D2WG | 0E | 0F |
| AX201.D2WG.NV | 0E | 0F |
| AX201.D2WG.NVW | 0D | 0E |
| AX201.D2WG.W | 0D | 0E |

5. Product TA# dash up.

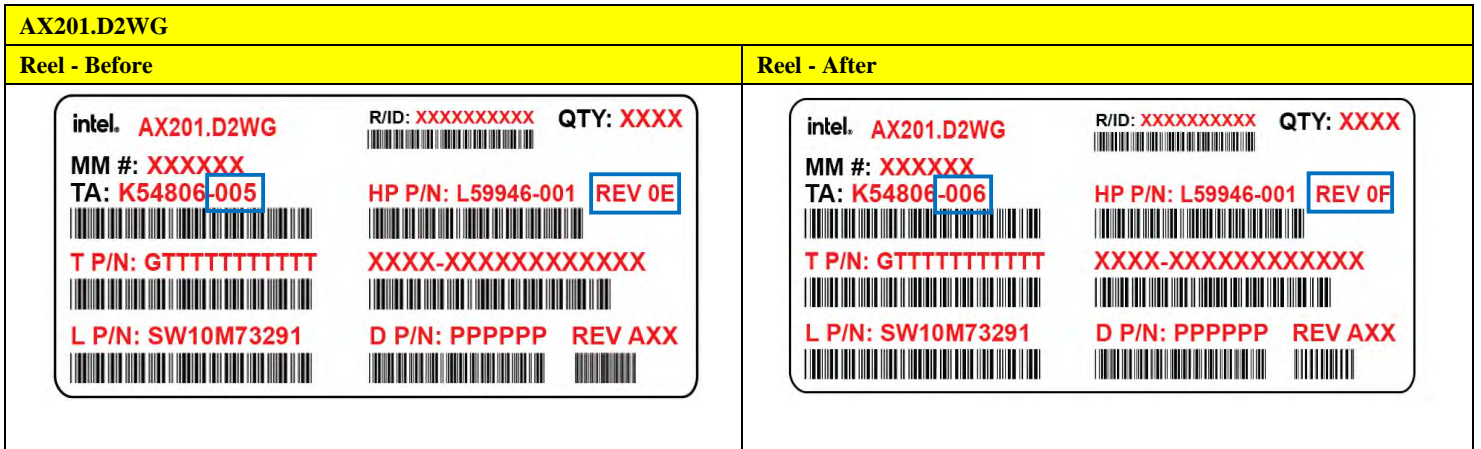
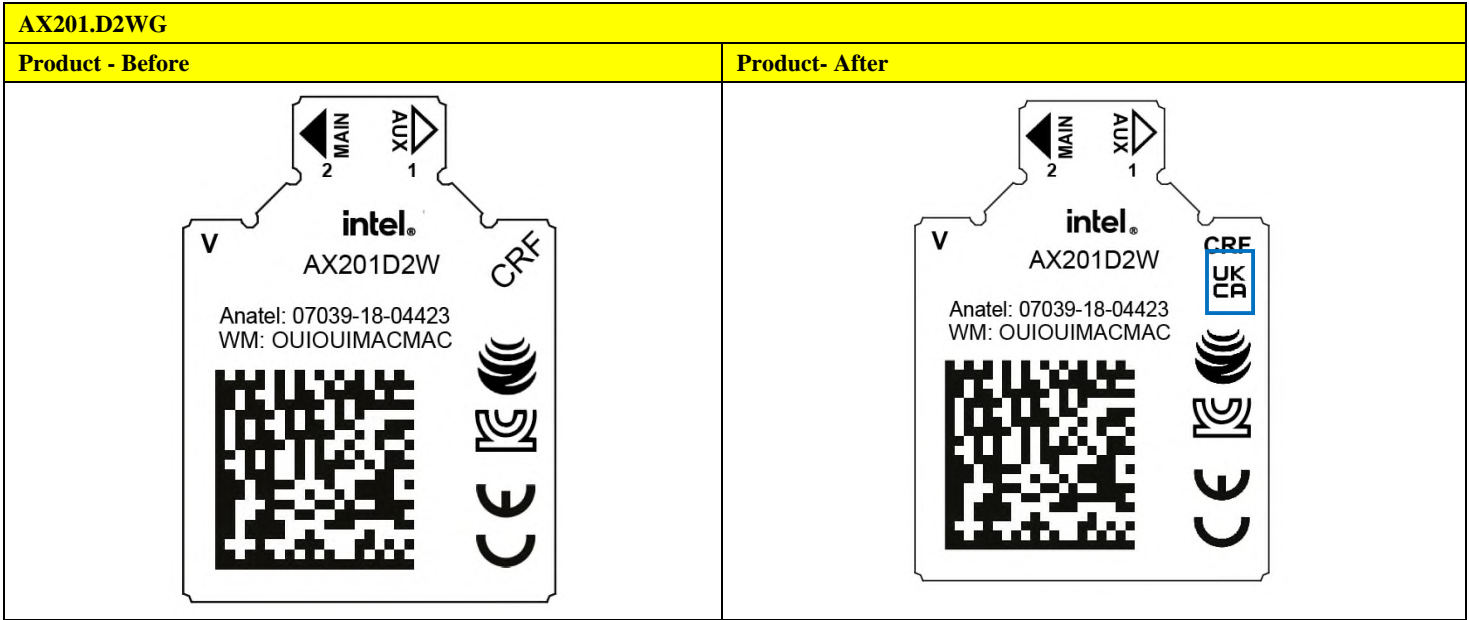

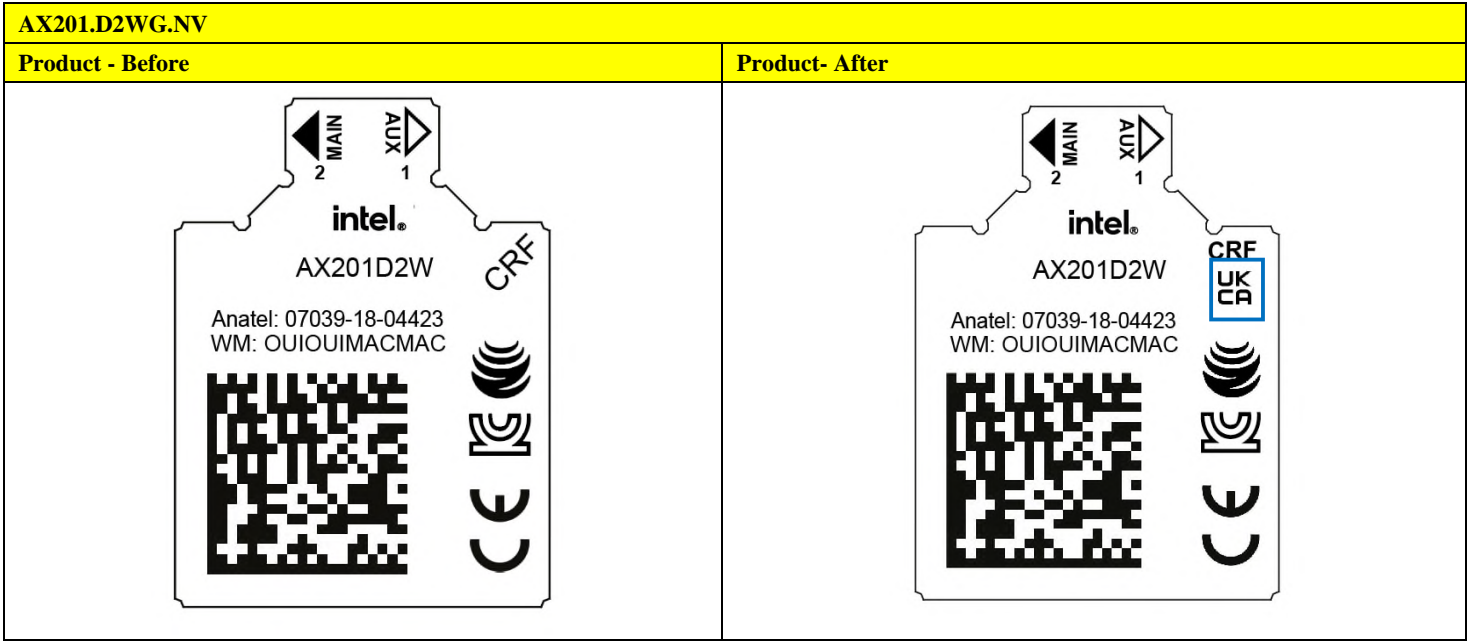

AX201.D2WG.NV
Disti-Before

| | | | | |
|--|--|--|---|---|
| <p>AX201.D2WG.NV</p> <p>VERSION #: K54807-005</p> <p>MADE IN XXXXX WITH PARTIAL FOREIGN CONTENT</p> <p>CARTON #: VVXXXXXXXX</p> | <p>MM#: XXXXXX</p> <p>PACK DATE: DD MMM YY</p> <p>PACKED BY: XXXXXX</p> <p>BATCH #: CCVVYMDRSS</p> | <p>QTY: 1000</p> <p>88334 00140 2</p> <p>9 310779 300005</p> | <p>Intel® Wi-Fi 6 AX201 (Model: AX201D2W)</p> <p>PKG ID (3S) VVVVMMMMDDC#####PPPPPP1000</p> <p>T P/N: GTTTTTTTTTTT</p> <p>D P/N: PPPPPP REV AXX HP P/N: L33637-001 REV: 0E</p> <p>Vendor ID Loc Id Mfg Id VVVVVLLLLL MMMMM </p> <p>L P/N: SW10M73292</p> <p>EC: 249G372</p> | <p>Intel Corporation 2200 Mission College Blvd Santa Clara, CA 95054-1549 USA www.intel.com</p> <p>COMMIT ID: 2018A7553 (M) APPROVED BY PTA 9.9115/2019</p> <p>Approved No: 17A1A38637A</p> <p>5.15-5 GHz (EIRP Indoor use only) (Energy contribution to total power radio) C-22445</p> <p>17180132003</p> <p>R-C-INT-AX201D2W</p> |
|--|--|--|---|---|

Disti-After

| | | | | |
|--|---|--|---|---|
| <p>AX201.D2WG.NV</p> <p>VERSION #: K54807-006</p> <p>MADE IN XXXXX WITH PARTIAL FOREIGN CONTENT</p> <p>CARTON #: VVXXXXXXXX</p> | <p>MM #: XXXXXX</p> <p>PACK DATE: DD MMM YY</p> <p>PACKED BY: XXXXXX</p> <p>BATCH #: CCVVYMDRSS</p> | <p>QTY: 1000</p> <p>88334 00140 2</p> <p>9 310779 300005</p> | <p>Intel® Wi-Fi 6 AX201 (Model: AX201D2W)</p> <p>PKG ID (3S) VVVVMMMMDDC#####PPPPPP1000</p> <p>T P/N: GTTTTTTTTTTT</p> <p>D P/N: PPPPPP REV AXX HP P/N: L33637-001 REV: 0F</p> <p>Vendor ID Loc Id Mfg Id VVVVVLLLLL MMMMM </p> <p>L P/N: SW10M73292</p> <p>EC: 249G372</p> | <p>Intel Corporation 2200 Mission College Blvd Santa Clara, CA 95054-1549 USA www.intel.com</p> <p>COMMIT ID: 2018A7553 (M) APPROVED BY PTA 9.9115/2019</p> <p>Approved No: 17A1A38637A</p> <p>5.15-5 GHz (EIRP Indoor use only) (Energy contribution to total power radio) C-22445</p> <p>17180132003</p> <p>R-C-INT-AX201D2W</p> |
|--|---|--|---|---|

AX201.D2WG.NV

| | |
|--|---|
| <p>Reel - Before</p> <p>intel. AX201.D2WG.NV R/ID: XXXXXXXXXXXX QTY: XXXX</p> <p>MM #: XXXXXX</p> <p>TA: K54807-005 HP P/N: L33637-001 REV 0E</p> <p>T P/N: GTTTTTTTTTTT XXXX-XXXXXXXXXXXX</p> <p>L P/N: SW10M73292 D P/N: PPPPPP REV AXX</p> | <p>Reel - After</p> <p>intel. AX201.D2WG.NV R/ID: XXXXXXXXXXXX QTY: XXXX</p> <p>MM #: XXXXXX</p> <p>TA: K54807-006 HP P/N: L33637-001 REV 0F</p> <p>T P/N: GTTTTTTTTTTT XXXX-XXXXXXXXXXXX</p> <p>L P/N: SW10M73292 D P/N: PPPPPP REV AXX</p> |
|--|---|

AX201.D2WG.W

Product - Before

Product - After

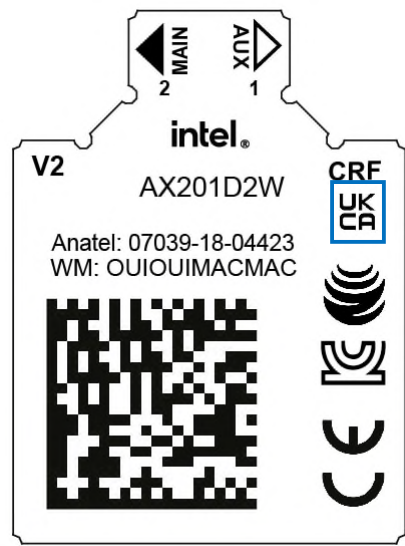
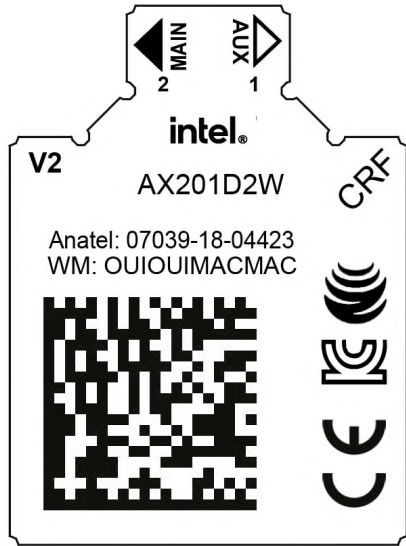

AX201.D2WG.W

Disti-Before

| | | | | |
|--|--|--|--|---|
| <p>AX201.D2WG.W</p> <p>VERSION #: K8321-004</p> <p>MADE IN XXXXX WITH PARTIAL FOREIGN CONTENT</p> <p>CARTON #: VVXXXXXXXXXX</p> | <p>MM#: XXXXXX</p> <p>PACK DATE: DD MMM YY</p> <p>PACKED BY: XXXXXX</p> <p>BATCH #: CCVVYMDRSS</p> | <p>QTY: 1000</p> <p>1 88334 00140 2</p> <p>9 310778 300005</p> | <p>Intel® Wi-Fi 6 AX201 (Model: AX201D2W)</p> <p>PKG ID (3S): VVVVVMMMMDDDDPPPPPP1000</p> <p>T P/N: GTTTTTTTTTTT</p> <p>D P/N: P P P P P P REV AX X HP P/N: L59946-002 REV: 0D</p> <p>Vendor ID Loc Id Mig Id L P/N: SW10T06455</p> <p>VVVVVLLLLL XXXXXX XXXXXX EC: 3417667</p> | <p>Intel Corporation 2200 Mission College Blvd Santa Clara, CA 95054-1549 USA www.intel.com</p> <p>CMIT ID: 2018AJ7503 (M) APPROVED BY PTA 0-91152016</p> <p>CCAH18LP3410T5</p> <p>003-180233</p> <p>5,15-5,35 GHz: Indoor use only (except commensurate to high power radio)</p> <p>0-91152003</p> <p>R-C-INT-AX201D2W</p> |
|--|--|--|--|---|

Disti-After

| | | | | |
|--|---|--|--|---|
| <p>AX201.D2WG.W</p> <p>VERSION #: K8321-005</p> <p>MADE IN XXXXX WITH PARTIAL FOREIGN CONTENT</p> <p>CARTON #: VVXXXXXXXXXX</p> | <p>MM #: XXXXXX</p> <p>PACK DATE: DD MMM YY</p> <p>PACKED BY: XXXXXX</p> <p>BATCH #: CCVVYMDRSS</p> | <p>QTY: 1000</p> <p>1 88334 00140 2</p> <p>9 310778 300005</p> | <p>Intel® Wi-Fi 6 AX201 (Model: AX201D2W)</p> <p>PKG ID (3S): VVVVVMMMMDDDDPPPPPP1000</p> <p>T P/N: GTTTTTTTTTTT</p> <p>D P/N: P P P P P P REV AX X HP P/N: L59946-002 REV: 0E</p> <p>Vendor ID Loc Id Mig Id L P/N: SW10T06455</p> <p>VVVVVLLLLL XXXXXX XXXXXX EC: 3417667</p> | <p>Intel Corporation 2200 Mission College Blvd Santa Clara, CA 95054-1549 USA www.intel.com</p> <p>CMIT ID: 2018AJ7503 (M) APPROVED BY PTA 0-91152016</p> <p>CCAH18LP3410T5</p> <p>003-180233</p> <p>5,15-5,35 GHz: Indoor use only (except commensurate to high power radio)</p> <p>0-91152003</p> <p>R-C-INT-AX201D2W</p> |
|--|---|--|--|---|

AX201.D2WG.W

Reel - Before

Reel - After

| | |
|--|--|
| <p>intel. AX201.D2WG.W</p> <p>R/ID: XXXXXXXXXXXX QTY: XXXX</p> <p>MM #: XXXXXX</p> <p>TA: K83212-004</p> <p>T P/N: GTTTTTTTTTTT</p> <p>L P/N: SW10T06455</p> | <p>HP P/N: L59946-002 REV 0D</p> <p>XXXX-XXXXXXXXXXXXXX</p> <p>D P/N: P P P P P P REV AX X</p> |
|--|--|

| | |
|--|--|
| <p>intel. AX201.D2WG.W</p> <p>R/ID: XXXXXXXXXXXX QTY: XXXX</p> <p>MM #: XXXXXX</p> <p>TA: K83212-005</p> <p>T P/N: GTTTTTTTTTTT</p> <p>L P/N: SW10T06455</p> | <p>HP P/N: L59946-002 REV 0E</p> <p>XXXX-XXXXXXXXXXXXXX</p> <p>D P/N: P P P P P P REV AX X</p> |
|--|--|

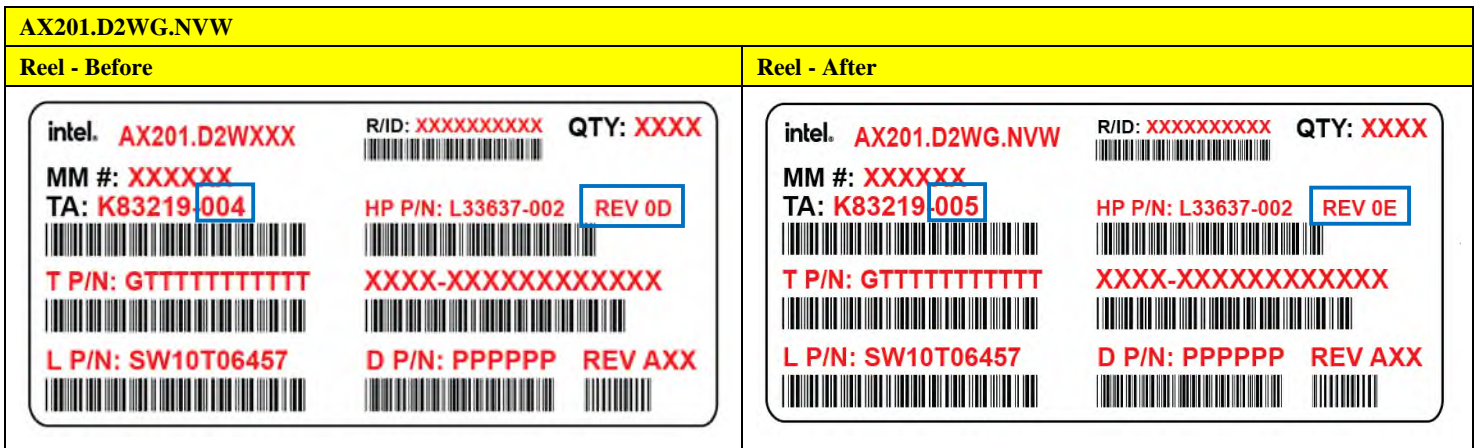
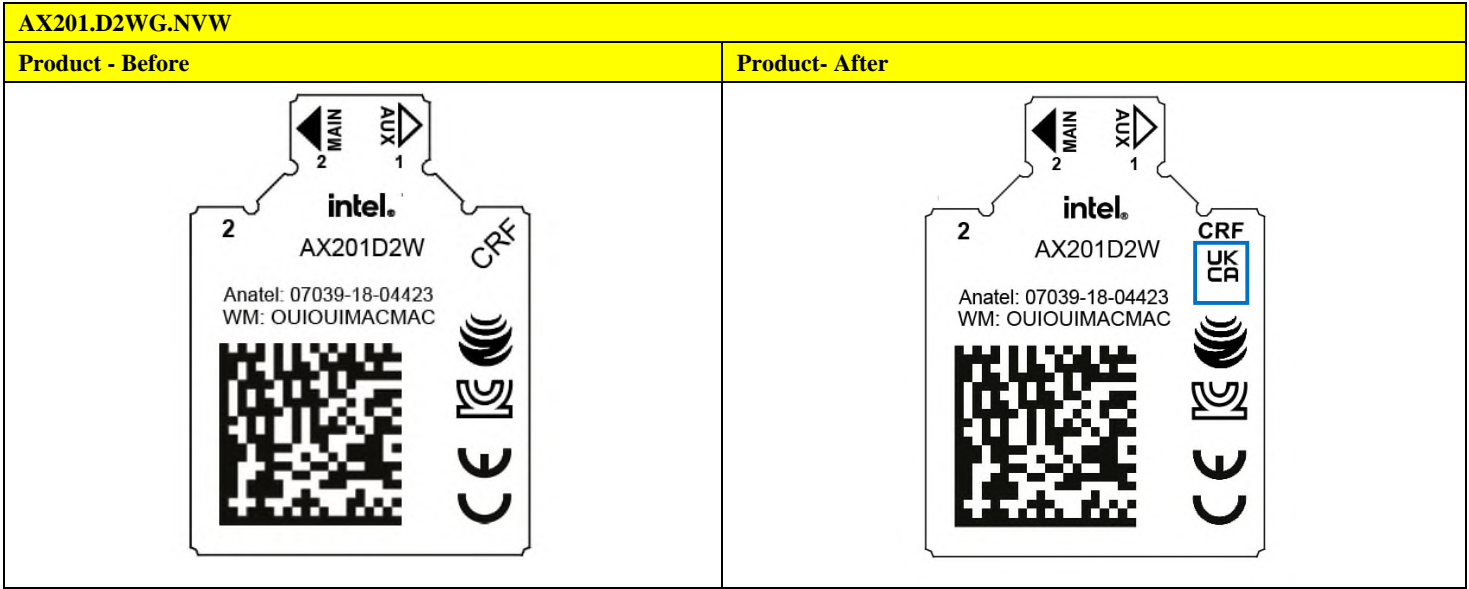

AX201.D2WG.LNVW

Product - Before

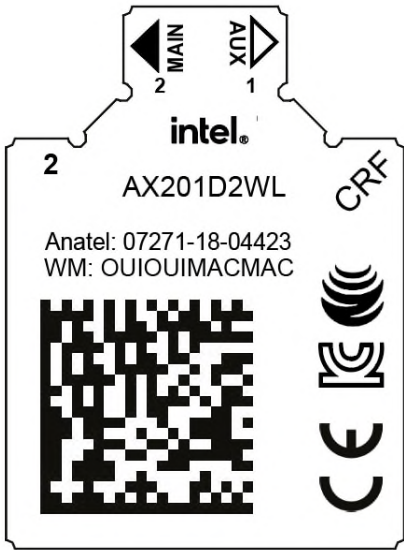

Product- After

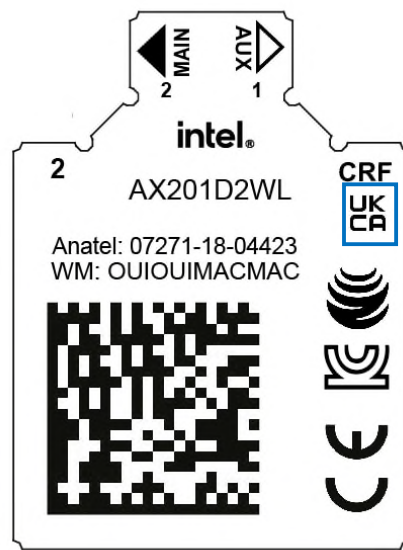

AX201.D2WG.LNVW

Disti-Before

| | | | | |
|--|--|--|--|---|
| <p>AX201.D2WG.LNVW</p> <p>VERSION #: K8350-004</p> <p>MADE IN XXXXX WITH PARTIAL FOREIGN CONTENT CARTON #: VVXXXXXXXX</p> | <p>MM#: XXXXXX</p> <p>PACK DATE: DD MMM YY PACKED BY: XXXXXX</p> <p>BATCH #: CCVYMDRSS</p> | <p>QTY: 1000</p> <p>88334 00140</p> <p>9 310779 300005</p> | <p>Intel® Wi-Fi 6 AX201 (Model: AX201D2WL)</p> <p>PKG ID (D5) VVVVMMMMDDRRSSPPPPPP1000</p> <p>T/PN: GTTTTTTTTT</p> <p>D P/N: PPPPPP REV: AXJ HP P/N: XXXXXX.JXX REV: XX</p> <p>Vendor ID Loc ID Mfg Id Mfg Mfg</p> <p>L P/N: XXXXXXXXXX EC: XXXXXXXX</p> | <p>Intel Corporation 2200 Mission College Blvd Santa Clara, CA 95054-1649 USA www.intel.com</p> <p>CCAH18LP4730T2</p> <p>003-180234</p> <p>0-15.25 GHz Indoor use only (Class II transmitter for high power radio)</p> <p>018113005</p> |
|--|--|--|--|---|

Disti-After

| | | | | |
|--|---|--|--|---|
| <p>AX201.D2WG.LNVW</p> <p>VERSION #: K8350-005</p> <p>MADE IN XXXXX WITH PARTIAL FOREIGN CONTENT CARTON #: VVXXXXXXXX</p> | <p>MM #: XXXXXX</p> <p>PACK DATE: DD MMM YY PACKED BY: XXXXXX</p> <p>BATCH #: CCVYMDRSS</p> | <p>QTY: 1000</p> <p>88334 00140</p> <p>9 310779 300005</p> | <p>Intel® Wi-Fi 6 AX201 (Model: AX201D2WL)</p> <p>PKG ID (D5) VVVVMMMMDDRRSSPPPPPP1000</p> <p>T/PN: GTTTTTTTTT</p> <p>D P/N: PPPPPP REV: AXJ HP P/N: XXXXXX.JXX REV: XX</p> <p>Vendor ID Loc ID Mfg Id Mfg Mfg</p> <p>L P/N: XXXXXXXXXX EC: XXXXXXXX</p> | <p>Intel Corporation 2200 Mission College Blvd Santa Clara, CA 95054-1649 USA www.intel.com</p> <p>CCAH18LP4730T2</p> <p>003-180234</p> <p>0-15.25 GHz Indoor use only (Class II transmitter for high power radio)</p> <p>018113005</p> |
|--|---|--|--|---|

AX201.D2WG.NXXW

Product - Before

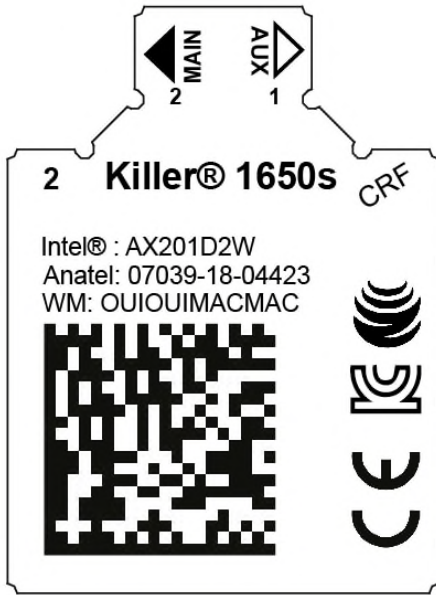

Product- After

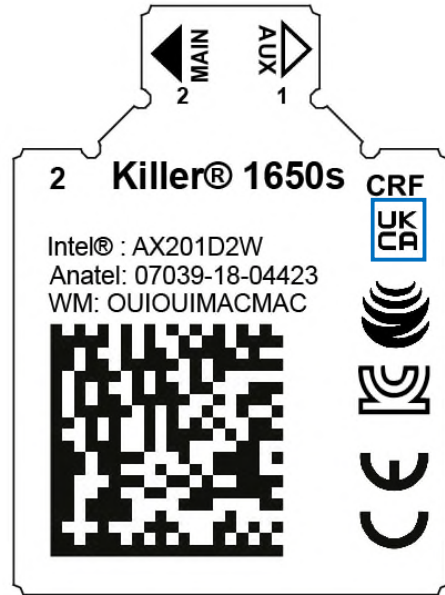

AX201.D2WG.NXXW

Disti-Before

| | | | |
|---|--|---|--|
| <p>AX201.D2WG.NXXW</p> <p>VERSION #: M1968-003</p> <p>MADE IN XXXX WITH PARTIAL FOREIGN CONTENT CARTON #: VVXXXXXXXX</p> | <p>MM#: XXXXXX</p> <p>PACK DATE: DD MMM YY PACKED BY: XXXXXX</p> <p>BATCH #: CCVVYMDRSS</p> | <p>QTY: 1000</p> <p>Intel® Wi-Fi 6 Killer-AX 1650s</p> <p>Intel® (Model: AX201D2W)</p> <p>PKG ID (3S) VVVVMMMMDDDD###PPPPPP1000</p> <p>Vendor ID Loc Id Mfg Id D PIN: XXXXXX REV AX</p> | <p>CE, UKCA, FCC, etc.</p> <p>Intel Corporation 2201 Mission College Blvd Santa Clara, CA 95054-1549 USA www.intel.com</p> <p>CCC, FCC, etc.</p> <p>CCC: CCAH18LP341075</p> <p>FCC: 2019-01023</p> <p>UKCA: 2019-01023</p> <p>UKCA: 2019-01023</p> |
|---|--|---|--|

Disti-After

| | | | |
|---|---|---|--|
| <p>AX201.D2WG.NXXW</p> <p>VERSION #: M1968-004</p> <p>MADE IN XXXX WITH PARTIAL FOREIGN CONTENT CARTON #: VVXXXXXXXX</p> | <p>MM #: XXXXXX</p> <p>PACK DATE: DD MMM YY PACKED BY: XXXXXX</p> <p>BATCH #: CCVVYMDRSS</p> | <p>QTY: 1000</p> <p>Intel® Wi-Fi 6 Killer-AX 1650s</p> <p>Intel® (Model: AX201D2W)</p> <p>PKG ID (3S) VVVVMMMMDDDD###PPPPPP1000</p> <p>Vendor ID Loc Id Mfg Id D PIN: XXXXXX REV AX</p> | <p>CE, UKCA, FCC, etc.</p> <p>Intel Corporation 2201 Mission College Blvd Santa Clara, CA 95054-1549 USA www.intel.com</p> <p>CCC, FCC, etc.</p> <p>CCC: CCAH18LP341075</p> <p>FCC: 2019-01023</p> <p>UKCA: 2019-01023</p> <p>UKCA: 2019-01023</p> |
|---|---|---|--|

Customer Impact of Change and Recommended Action:

The marking and label changes do not affect functionality. Intel anticipates no impact to customers. Intel will attempt to deplete pre-conversion material before shipping post-conversion material but there is a possibility of Intel shipping mixed inventory. Therefore, customers will need to manage and migrate to the post-conversion material as soon as possible.

Milestone dates are estimates and subject to change based on business and operational conditions.

Please contact your local Intel Field Sales Rep if you have any further questions about these changes

Products Affected/Intel Ordering Codes:

| Marketing Name | Product Code | MM# | Pre Change TA | Post Change TA |
|---|-----------------|--------|---------------|----------------|
| Intel® Wi-Fi 6 AX201 (Gig+), 1216, 2x2 AX+BT, vPro® | AX201.D2WG | 985857 | K54806-005 | K54806-006 |
| Intel® Wi-Fi 6 AX201 (Gig+), 1216, 2x2 AX+BT, No vPro® | AX201.D2WG.NV | 985868 | K54807-005 | K54807-006 |
| Intel® Wi-Fi 6 AX201 (Gig+), 1216, 2x2 AX+BT, vPro® | AX201.D2WG.W | 999TDM | K83212-004 | K83212-005 |
| Intel® Wi-Fi 6 AX201 (Gig+), 1216, 2x2 AX+BT, No vPro® | AX201.D2WG.NVW | 999TDN | K83219-004 | K83219-005 |
| Intel® Wi-Fi 6 AX201 (Gig+), 1216, 2x2 AX+BT, vPro®, LTE Coex | AX201.D2WG.LW | 999TDP | K83498-004 | K83498-005 |
| Intel® Wi-Fi 6 AX201 (Gig+), 1216, 2x2 AX+BT, No vPro®, LTE Coex | AX201.D2WG.LNVW | 999TDR | K83504-004 | K83504-005 |
| Intel® Killer™ Wi-Fi 6 AX1650 s (Gig+), 1216, 2x2 AX+BT, No vPro® | AX201.D2WG.NXXW | 99A780 | M19688-003 | M19688-004 |

PCN Revision History:

Date of Revision:

November 19, 2021

Revision Number:

00

Reason:

Originally Published PCN



Product Change Notification

118676-00

INFORMATION IN THIS DOCUMENT IS PROVIDED IN CONNECTION WITH INTEL PRODUCTS. NO LICENSE, EXPRESS OR IMPLIED, BY ESTOPPEL OR OTHERWISE, TO ANY INTELLECTUAL PROPERTY RIGHTS IS GRANTED BY THIS DOCUMENT. EXCEPT AS PROVIDED IN INTEL'S TERMS AND CONDITIONS OF SALE FOR SUCH PRODUCTS, INTEL ASSUMES NO LIABILITY WHATSOEVER AND INTEL DISCLAIMS ANY EXPRESS OR IMPLIED WARRANTY, RELATING TO SALE AND/OR USE OF INTEL PRODUCTS INCLUDING LIABILITY OR WARRANTIES RELATING TO FITNESS FOR A PARTICULAR PURPOSE, MERCHANTABILITY, OR INFRINGEMENT OF ANY PATENT, COPYRIGHT OR OTHER INTELLECTUAL PROPERTY RIGHT.

A "Mission Critical Application" is any application in which failure of the Intel Product could result, directly or indirectly, in personal injury or death. SHOULD YOU PURCHASE OR USE INTEL'S PRODUCTS FOR ANY SUCH MISSION CRITICAL APPLICATION, YOU SHALL INDEMNIFY AND HOLD INTEL AND ITS SUBSIDIARIES, SUBCONTRACTORS AND AFFILIATES, AND THE DIRECTORS, OFFICERS, AND EMPLOYEES OF EACH, HARMLESS AGAINST ALL CLAIMS COSTS, DAMAGES, AND EXPENSES AND REASONABLE ATTORNEYS' FEES ARISING OUT OF, DIRECTLY OR INDIRECTLY, ANY CLAIM OF PRODUCT LIABILITY, PERSONAL INJURY, OR DEATH ARISING IN ANY WAY OUT OF SUCH MISSION CRITICAL APPLICATION, WHETHER OR NOT INTEL OR ITS SUBCONTRACTOR WAS NEGLIGENT IN THE DESIGN, MANUFACTURE, OR WARNING OF THE INTEL PRODUCT OR ANY OF ITS PARTS.

Intel may make changes to specifications and product descriptions at any time, without notice. Designers must not rely on the absence or characteristics of any features or instructions marked "reserved" or "undefined". Intel reserves these for future definition and shall have no responsibility whatsoever for conflicts or incompatibilities arising from future changes to them. The information here is subject to change without notice. Do not finalize a design with this information.

The products described in this document may contain design defects or errors known as errata which may cause the product to deviate from published specifications. Current characterized errata are available on request.

Should you have any issues with the timeline or content of this change, please contact the Intel Representative(s) for your geographic location listed below. No response from customers will be deemed as acceptance of the change and the change will be implemented pursuant to the key milestones set forth in this attached PCN.

Americas Contact: asmo.pcn@intel.com

Asia Pacific/PRC Contact: apacgccb@intel.com

Europe Email: eccb@intel.com

Japan Email: jccb.ijkk@intel.com

Copyright © Intel Corporation 2021. Other names and brands may be claimed as the property of others.

3D XPoint, Axxia, Basis, Basis Peak, BlueMoon, BunnyPeople, Celeron, Centrino, Cilk, Curie, Flexpipe, Intel, the Intel logo, Intel Atom, Intel CoFluent, Intel Core, Intel. Experience What's Inside, the Intel. Experience What's Inside logo, Intel Inside, the Intel Inside logo, Intel Insider, Intel Joule, Intel RealSense, Intel SingleDriver, Intel SpeedStep, Intel Unite, Intel vPro, Intel Xeon Phi, Intel XScale, InTru, the InTru logo, the InTru Inside logo, InTru soundmark, Iris, Itanium, MCS, MMX, Optane, Ostro, Pali, Pentium, picoArray, Picochip, picoXcell, Puma, Quark, SMARTi, Soletta, Sound Mark, StarPro, Stay With It, the Engineering Stay With It logo, StreamSight, Tarari, The Journey Inside, Thunderbolt, the Thunderbolt logo, Transcede, True Key, Ultrabook, VTune, Xeon, X-GOLD, XMM, X-PMU and XPOSYS are trademarks of Intel Corporation or its subsidiaries in the U.S. and/or other countries.

Microsoft, Windows, and the Windows logo are trademarks, or registered trademarks of Microsoft Corporation in the United States and/or other countries. Java is a registered trademark of Oracle and/or its affiliates. Bluetooth is a trademark owned by its proprietor and used by Intel Corporation under license. Intel Corporation uses the Palm OS* Ready mark under license from Palm, Inc. OpenCL and the OpenCL logo are trademarks of Apple Inc. used by permission by Khronos.

Learn how to use Intel Trademarks and Brands correctly at <http://www.intel.com/intel/legal/tmusage2.htm>.