



Product Change Notification

Change Notification #: 119502-00

Change Title: Select Intel® Wi-Fi 6E AX210 SKUs,
PCN 119502-00, Label,
Box Artwork and Label Updates

Date of Publication: March 24, 2023

Key Characteristics of the Change:

Label

Forecasted Key Milestones:

Date Customer Must be Ready to Receive Post-Conversion Material	April 15, 2023
--	----------------

Description of Change to the Customer:

The Intel® Wi-Fi 6E AX210 2230 SKUs listed in the products affected table below will undergo the following changes.

1. Update Japan regulatory ID with Wi-Fi 6E certification on Distri box label (Not applicable to AX210.NGWGE.NVK and AX210.NGWGL.NVK).
2. Box artwork change for AX210.NGWGE.NVK and AX210.NGWGL.NVK

AX210.NGWGE.NVK

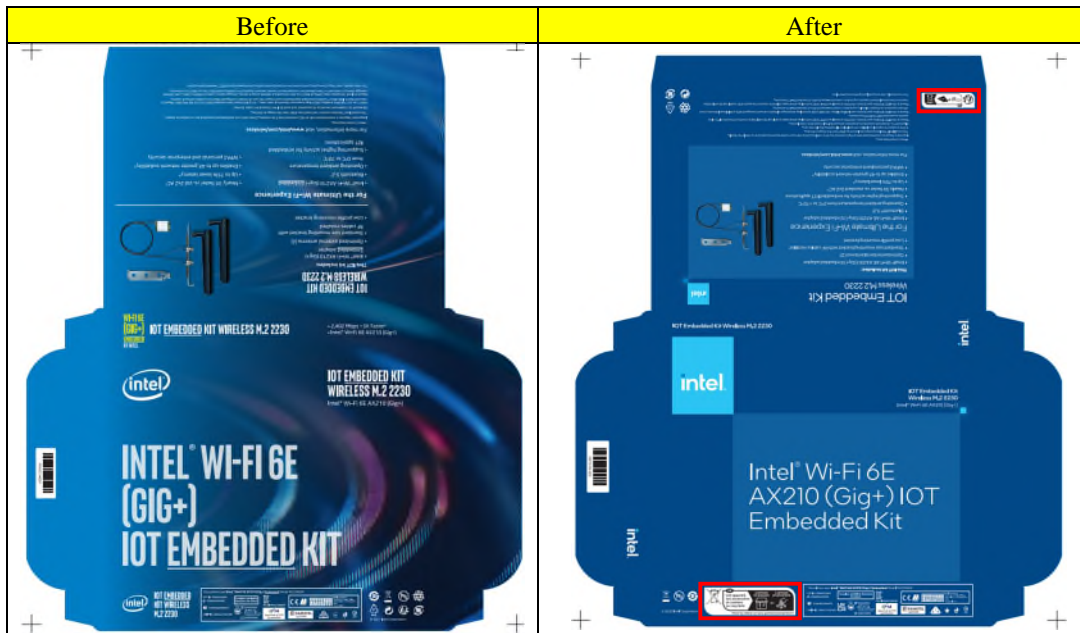



3. Product TA# dash up

Label Artwork (Before/After)

Label Artwork with TA changes only - Product Label



Note: TA equivalent to TA number. Please refer table below for exact TA.

Table TA Dash-Up

Product code	TA Before	TA After
AX210.NGWGIE	M37492-004	M37492-005
AX210.NGWGIE. NV	M37496-004	M37496-005
AX210.NGWGII	M37474-004	M37474-005
AX210.NGWGII. NV	M37480-004	M37480-005

Label Artwork with TA changes only - Product Label

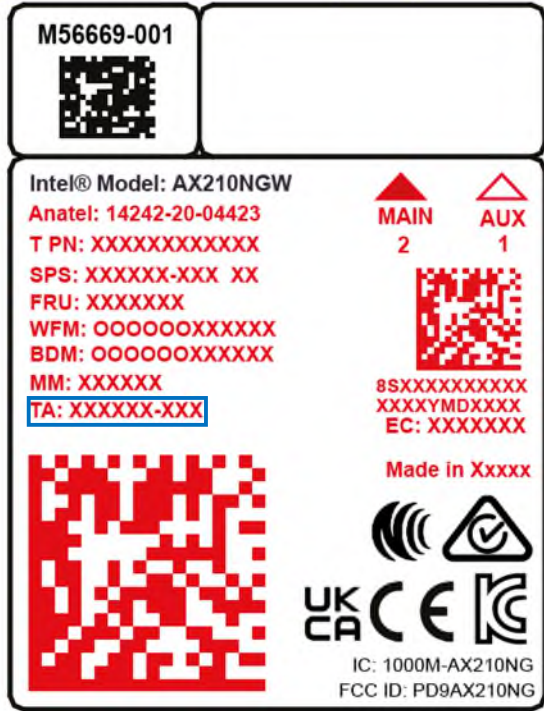

Note: TA equivalent to TA number. Please refer table below for exact TA.

Table TA Dash-Up

Product code	TA Before	TA After
AX210.NGWGE.NVK	M56666-004	M56666-005

Label Artwork with TA changes only - Product Label



Note: TA equivalent to TA number. Please refer table below for exact TA.

Table TA Dash-Up

Product code	TA Before	TA After
AX210.NGWGL.NVK	M56546-004	M56546-005

Disti – Before AX210.NGWGIE

<p>AX210.NGWGIE</p> <p>VERSION #: M37492-004</p> <p>MADE IN XXXXX WITH PARTIAL FOREIGN CONTENT</p> <p>CARTON #: VVXXXXXXXX</p>	<p>QTY: 100</p> <p>MM #: XXXXXX</p> <p>PACK DATE: DD MMM YY PACKED BY: XXXXXX</p> <p>BATCH #: CCVYMDRSS</p>	<p>Intel® Wi-Fi 6E AX210 (Model: AX210NGW)</p> <p>PKG ID (3S) VVVVMMMMDDDD#####XXXXXX100</p> <p>T P/N: XXXXXXXXXXXXX</p> <p>D P/N: XXXXXX REV: AXX HP P/N: XXXXXX-XXX REV: XX</p> <p>Vendor ID Loc Id Mfg Id</p> <p>L P/N: XXXXXXXXXXXX</p>	<p>CE UK CA</p> <p>AT BE BG CH CY CZ DE DK EE EL ES FR GR HR HU IE IS IT LI LT LU LV MT NL PL PT RO SE SI SK TR UK (NI)</p> <p>Intel Corporation 2200 Mission College Blvd Santa Clara, CA 95054-1549 USA www.intel.com</p> <p>CMIT ID: 2020A11402 (M)</p> <p>APPROVED BY PTA S 1020250</p> <p>UK CA</p> <p>UK 202-202239 [M]TA-P1011320 S 10-5.35 GHz indoor use only [L] 0220183023</p> <p>R-C-INT-AX210NGW</p>
---	---	---	---

Disti – After AX210.NGWGIE

<p>AX210.NGWGIE</p> <p>VERSION #: M37492-005</p> <p>MADE IN XXXXX WITH PARTIAL FOREIGN CONTENT</p> <p>CARTON #: VVXXXXXXXX</p>	<p>QTY: 100</p> <p>MM #: XXXXXX</p> <p>PACK DATE: DD MMM YY PACKED BY: XXXXXX</p> <p>BATCH #: CCVYMDRSS</p>	<p>Intel® Wi-Fi 6E AX210 (Model: AX210NGW)</p> <p>PKG ID (3S) VVVVMMMMDDDD#####XXXXXX100</p> <p>T P/N: XXXXXXXXXXXXX</p> <p>D P/N: XXXXXX REV: AXX HP P/N: XXXXXX-XXX REV: XX</p> <p>Vendor ID Loc Id Mfg Id</p> <p>L P/N: XXXXXXXXXXXX</p>	<p>CE UK CA</p> <p>AT BE BG CH CY CZ DE DK EE EL ES FR GR HR HU IE IS IT LI LT LU LV MT NL PL PT RO SE SI SK TR UK (NI)</p> <p>Intel Corporation 2200 Mission College Blvd Santa Clara, CA 95054-1549 USA www.intel.com</p> <p>CMIT ID: 2020A11402 (M)</p> <p>APPROVED BY PTA S 1020250</p> <p>UK CA</p> <p>UK 202-202254 [M]TA-P1011320 S 10-5.35 GHz indoor use only [L] 0220183023</p> <p>R-C-INT-AX210NGW</p>
---	---	---	---

Disti – Before AX210.NGWGIE.NV

<p>AX210.NGWGIE.NV</p> <p>VERSION #: M37496-004</p> <p>MADE IN XXXXX WITH PARTIAL FOREIGN CONTENT</p> <p>CARTON #: VVXXXXXXXX</p>	<p>QTY: 100</p> <p>MM #: XXXXXX</p> <p>PACK DATE: DD MMM YY PACKED BY: XXXXXX</p> <p>BATCH #: CCVYMDRSS</p>	<p>Intel® Wi-Fi 6E AX210 (Model: AX210NGW)</p> <p>PKG ID (3S) VVVVMMMMDDDD#####XXXXXX100</p> <p>T P/N: XXXXXXXXXXXXX</p> <p>D P/N: XXXXXX REV: AXX HP P/N: XXXXXX-XXX REV: XX</p> <p>Vendor ID Loc Id Mfg Id</p> <p>L P/N: XXXXXXXXXXXX</p>	<p>CE UK CA</p> <p>AT BE BG CH CY CZ DE DK EE EL ES FR GR HR HU IE IS IT LI LT LU LV MT NL PL PT RO SE SI SK TR UK (NI)</p> <p>Intel Corporation 2200 Mission College Blvd Santa Clara, CA 95054-1549 USA www.intel.com</p> <p>CMIT ID: 2020A11402 (M)</p> <p>APPROVED BY PTA S 1020250</p> <p>UK CA</p> <p>UK 202-202239 [M]TA-P1011320 S 10-5.35 GHz indoor use only [L] 0220183023</p> <p>R-C-INT-AX210NGW</p>
--	---	---	---

Disti – After AX210.NGWGIE.NV

<p>AX210.NGWGIE.NV</p> <p>VERSION #: M37496-005</p> <p>MADE IN XXXXX WITH PARTIAL FOREIGN CONTENT</p> <p>CARTON #: VVXXXXXXXX</p>	<p>QTY: 100</p> <p>MM #: XXXXXX</p> <p>PACK DATE: DD MMM YY PACKED BY: XXXXXX</p> <p>BATCH #: CCVYMDRSS</p>	<p>Intel® Wi-Fi 6E AX210 (Model: AX210NGW)</p> <p>PKG ID (3S) VVVVMMMMDDDD#####XXXXXX100</p> <p>T P/N: XXXXXXXXXXXXX</p> <p>D P/N: XXXXXX REV: AXX HP P/N: XXXXXX-XXX REV: XX</p> <p>Vendor ID Loc Id Mfg Id</p> <p>L P/N: XXXXXXXXXXXX</p>	<p>CE UK CA</p> <p>AT BE BG CH CY CZ DE DK EE EL ES FR GR HR HU IE IS IT LI LT LU LV MT NL PL PT RO SE SI SK TR UK (NI)</p> <p>Intel Corporation 2200 Mission College Blvd Santa Clara, CA 95054-1549 USA www.intel.com</p> <p>CMIT ID: 2020A11402 (M)</p> <p>APPROVED BY PTA S 1020250</p> <p>UK CA</p> <p>UK 202-202234 [M]TA-P1011320 S 10-5.35 GHz indoor use only [L] 0220183023</p> <p>R-C-INT-AX210NGW</p>
--	---	---	---

Disti – Before AX210.NGWGII

<p>AX210.NGWGII</p> <p>VERSION #: M37474-004</p> <p>MADE IN XXXXX WITH PARTIAL FOREIGN CONTENT CARTON #: VVXXXXXXX</p>	<p>MM #: XXXXXX</p> <p>PACK DATE: DD MMM YY PACKED BY: XXXXXX</p> <p>BATCH #: CCVYMDR55</p>	<p>QTY: 100</p> <p>88334 00140 2</p> <p>9 310779 300005</p>	<p>Intel® Wi-Fi 6E AX210 (Model: AX210NGW)</p> <p>PKG ID (3S) VVVVMMMMDDDD#####XXXXX100 T PIN: XXXXXXXXXX</p> <p>D P/N: XXXXXX REV AXJX HP P/N: XXXXXX-XXX REV: XX</p> <p>Vendor ID Loc Id Mfg Id L P/N: SW11A40423</p> <p>EC: 4732779</p>	<p>Intel Corporation 2200 Mission College Blvd Santa Clara, CA 95054-1549 USA www.intel.com</p> <p>CMIT ID: 2020AJ11402 (M)</p> <p>APPROVED BY PFA S 10092202</p> <p>Applicant No: 028009</p> <p>029-202209 (Intel AX210 1600)</p> <p>5.15-6.0 GHz Indoor use only Bandwidth commensurate to high power radio</p> <p>0220193023</p> <p>R-C-INT-AX210NGW</p>
---	---	---	--	---

Disti – After AX210.NGWGII

<p>AX210.NGWGII</p> <p>VERSION #: M37474-005</p> <p>MADE IN XXXXX WITH PARTIAL FOREIGN CONTENT CARTON #: VVXXXXXXX</p>	<p>MM #: XXXXXX</p> <p>PACK DATE: DD MMM YY PACKED BY: XXXXXX</p> <p>BATCH #: CCVYMDR55</p>	<p>QTY: 100</p> <p>88334 00140 2</p> <p>9 310779 300005</p>	<p>Intel® Wi-Fi 6E AX210 (Model: AX210NGW)</p> <p>PKG ID (3S) VVVVMMMMDDDD#####XXXXX100 T PIN: XXXXXXXXXX</p> <p>D P/N: XXXXXX REV AXJX HP P/N: XXXXXX-XXX REV: XX</p> <p>Vendor ID Loc Id Mfg Id L P/N: SW11A40423</p> <p>EC: 4732779</p>	<p>Intel Corporation 2200 Mission College Blvd Santa Clara, CA 95054-1549 USA www.intel.com</p> <p>CMIT ID: 2020AJ11402 (M)</p> <p>APPROVED BY PFA S 10092202</p> <p>Applicant No: 028009</p> <p>029-202209 (Intel AX210 1600)</p> <p>5.15-6.0 GHz Indoor use only Bandwidth commensurate to high power radio</p> <p>0220193023</p> <p>R-C-INT-AX210NGW</p>
---	---	---	--	---

Disti – Before AX210.NGWGII.NV

<p>AX210.NGWGII.NV</p> <p>VERSION #: M37480-004</p> <p>MADE IN XXXXX WITH PARTIAL FOREIGN CONTENT CARTON #: VVXXXXXXX</p>	<p>MM #: XXXXXX</p> <p>PACK DATE: DD MMM YY PACKED BY: XXXXXX</p> <p>BATCH #: CCVYMDR55</p>	<p>QTY: 100</p> <p>88334 00140 2</p> <p>9 310779 300005</p>	<p>Intel® Wi-Fi 6E AX210 (Model: AX210NGW)</p> <p>PKG ID (3S) VVVVMMMMDDDD#####XXXXX100 T PIN: XXXXXXXXXX</p> <p>D P/N: XXXXXX REV AXJX HP P/N: XXXXXX-XXX REV: XX</p> <p>Vendor ID Loc Id Mfg Id L P/N: SW11A40424</p> <p>EC: 4732779</p>	<p>Intel Corporation 2200 Mission College Blvd Santa Clara, CA 95054-1549 USA www.intel.com</p> <p>CMIT ID: 2020AJ11402 (M)</p> <p>APPROVED BY PFA S 10092202</p> <p>Applicant No: 028009</p> <p>029-202209 (Intel AX210 1600)</p> <p>5.15-6.0 GHz Indoor use only Bandwidth commensurate to high power radio</p> <p>0220193023</p> <p>R-C-INT-AX210NGW</p>
--	---	---	--	---

Disti – After AX210.NGWGII.NV

<p>AX210.NGWGII.NV</p> <p>VERSION #: M37480-005</p> <p>MADE IN XXXXX WITH PARTIAL FOREIGN CONTENT CARTON #: VVXXXXXXX</p>	<p>MM #: XXXXXX</p> <p>PACK DATE: DD MMM YY PACKED BY: XXXXXX</p> <p>BATCH #: CCVYMDR55</p>	<p>QTY: 100</p> <p>88334 00140 2</p> <p>9 310779 300005</p>	<p>Intel® Wi-Fi 6E AX210 (Model: AX210NGW)</p> <p>PKG ID (3S) VVVVMMMMDDDD#####XXXXX100 T PIN: XXXXXXXXXX</p> <p>D P/N: XXXXXX REV AXJX HP P/N: XXXXXX-XXX REV: XX</p> <p>Vendor ID Loc Id Mfg Id L P/N: SW11A40424</p> <p>EC: 4732779</p>	<p>Intel Corporation 2200 Mission College Blvd Santa Clara, CA 95054-1549 USA www.intel.com</p> <p>CMIT ID: 2020AJ11402 (M)</p> <p>APPROVED BY PFA S 10092202</p> <p>Applicant No: 028009</p> <p>029-202209 (Intel AX210 1600)</p> <p>5.15-6.0 GHz Indoor use only Bandwidth commensurate to high power radio</p> <p>0220193023</p> <p>R-C-INT-AX210NGW</p>
--	---	---	--	---

Label Artwork with TA changes only - Bracket Label (Industrial kit)



Note: TA equivalent to TA number. Please refer table below for exact TA.

Table TA Dash-Up

Product Code	TA Before	TA After
AX210.NGWGL.NVK	M56545-004	M56545-005

Label Artwork with TA changes only - Bracket Label (Embedded Kit)

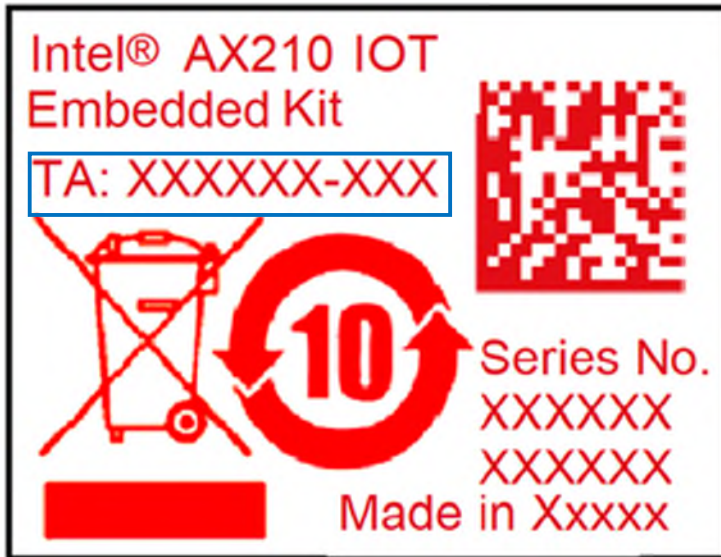

Note: TA equivalent to TA number. Please refer table below for exact TA.

Table TA Dash-Up

Product Code	TA Before	TA After
AX210.NGWGE.NVK	M56665-004	M56665-005

Customer Impact of Change and Recommended Action:

The label and box artwork change to the products do not affect functionality.

Intel will attempt to deplete pre-conversion material before shipping post-conversion material but there is a possibility of Intel shipping mixed inventory. Therefore, customers will need to manage and migrate to the post-conversion material as soon as possible.

Milestone dates are estimates and subject to change based on business and operational conditions.

Please contact your local Intel Field Sales Representative if you have any further questions about these changes

Products Affected/Intel Ordering Codes:

Marketing Name	Product Code	MM#	Pre Change TA	Post Change TA
Intel® Wi-Fi 6E AX210 (Gig+), 2230, 2x2 AX R2 (6GHz)+BT, No vPro®	AX210.NGWGII.NV	99ARN6	M37480-004	M37480-005
Intel® Wi-Fi 6E AX210 (Gig+), 2230, 2x2 AX R2 (6GHz)+BT, No vPro®, Industrial, Extended Temp	AX210.NGWGI.NVK	99AP9J	M56546-004	M56546-005
Intel® Wi-Fi 6E AX210 (Gig+), 2230, 2x2 AX R2 (6GHz)+BT, Embedded, No vPro®	AX210.NGWGE.NVK	99AP9N	M56666-004	M56666-005
Intel® Wi-Fi 6E AX210 (Gig+), 2230, 2x2 AX R2 (6GHz)+BT, No vPro®	AX210.NGWGIE.NV	99ARN4	M37496-004	M37496-005
Intel® Wi-Fi 6E AX210 (Gig+), 2230, 2x2 AX R2 (6GHz)+BT, vPro®	AX210.NGWGIE	99ARN5	M37492-004	M37492-005
Intel® Wi-Fi 6E AX210 (Gig+), 2230, 2x2 AX R2 (6GHz)+BT, vPro®	AX210.NGWGII	99ARN7	M37474-004	M37474-005

PCN Revision History:

Date of Revision:

March 24, 2023

Revision Number:

00

Reason:

Originally Published PCN



Product Change Notification

119502-00

Notices & Disclaimers

No license (express or implied, by estoppel or otherwise) to any intellectual property rights is granted by this document.

Intel disclaims all express and implied warranties, including without limitation, the implied warranties of merchantability, fitness for a particular purpose, and non-infringement, as well as any warranty arising from course of performance, course of dealing, or usage in trade, except as provided in a separate written agreement.

You may not use or facilitate the use of this document in connection with any infringement or other legal analysis concerning Intel products described herein. You agree to grant Intel a non-exclusive, royalty-free license to any patent claim thereafter drafted which includes the subject matter disclosed herein.

The products described may contain design defects or errors known as errata which may cause the product to deviate from published specifications. Current characterized errata are available on request.

Statements in this document that refer to future plans or expectations are forward-looking statements. These statements are based on current expectations and involve many risks and uncertainties that could cause actual results to differ materially from those expressed or implied in such statements. For more information on the factors that could cause actual results to differ materially, see our most recent earnings release and SEC filings at www.intc.com.

Customer is responsible for safety of the overall system, including compliance with applicable safety-related requirements or standards.

Intel technologies may require enabled hardware, software or service activation.

No product or component can be absolutely secure.

Your costs and results may vary.

©Intel Corporation. Intel, the Intel logo, and other Intel marks are trademarks of Intel Corporation or its subsidiaries. Other names and brands may be claimed as the property of others.

No response from customers will be deemed an acceptance of the change, and the change will be implemented pursuant to the key milestones set forth in this attached PCN.

Should you have any issues with the timeline or content of this change, please contact the Intel Representative(s) for your geographic location listed below.

Americas Contact: asmo.pcn@intel.com

Asia Pacific/PRC Contact: apacgccb@intel.com

Europe Email: eccb@intel.com

Japan Email: jccb.ijkk@intel.com