



# Product Change Notification

**Change Notification #:** 118253-00  
**Change Title:** Select Intel® Wireless 7200 Series,  
PCN 118253-00, Label, Transport Media  
Label and Packaging updates  
**Date of Publication:** May 12, 2021

**Key Characteristics of the Change:**  
Label, Transport Media

## Forecasted Key Milestones:

<b>Date Customer Must be Ready to Receive Post-Conversion Material:</b>	May 31, 2021
---	--------------

## Description of Change to the Customer:

The Intel® Wireless-AC7265 1216 SKUs listed in the products affected table below will undergo the following changes.

1. Update packaging kit from H55770-001 to H55770-002 (Remove old Intel logo from pizza box).

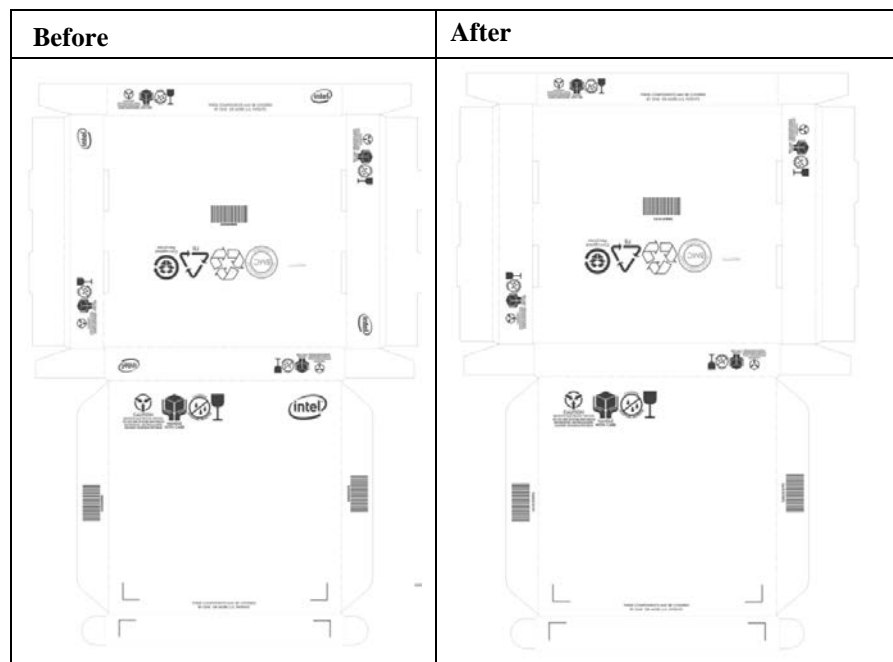

2. Update Intel logo on reel label and product label (laser marking).

- Update Singapore IMDA ID.
- Update UK/Brexit table on Disti label.
- The Intel tracking revision will be changed on the following products

Product Code	Before	After
7265.D2WG.W	0F	0G
7265.D2WG18V.S1	0H	0I

- Product TA# dash up.

### Example Labels

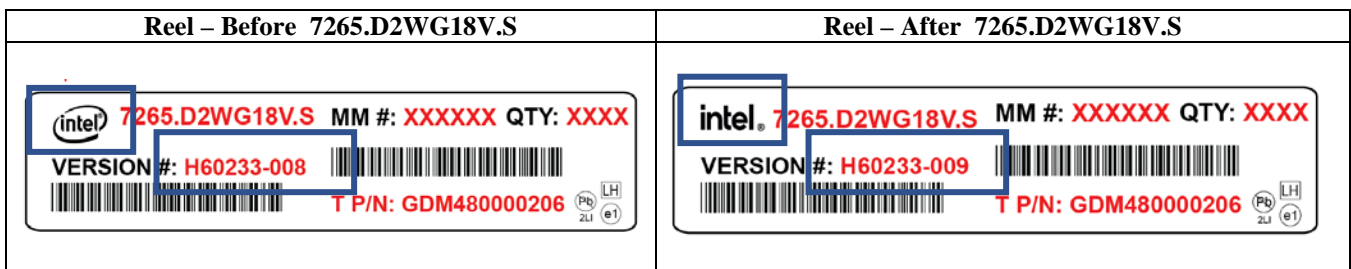
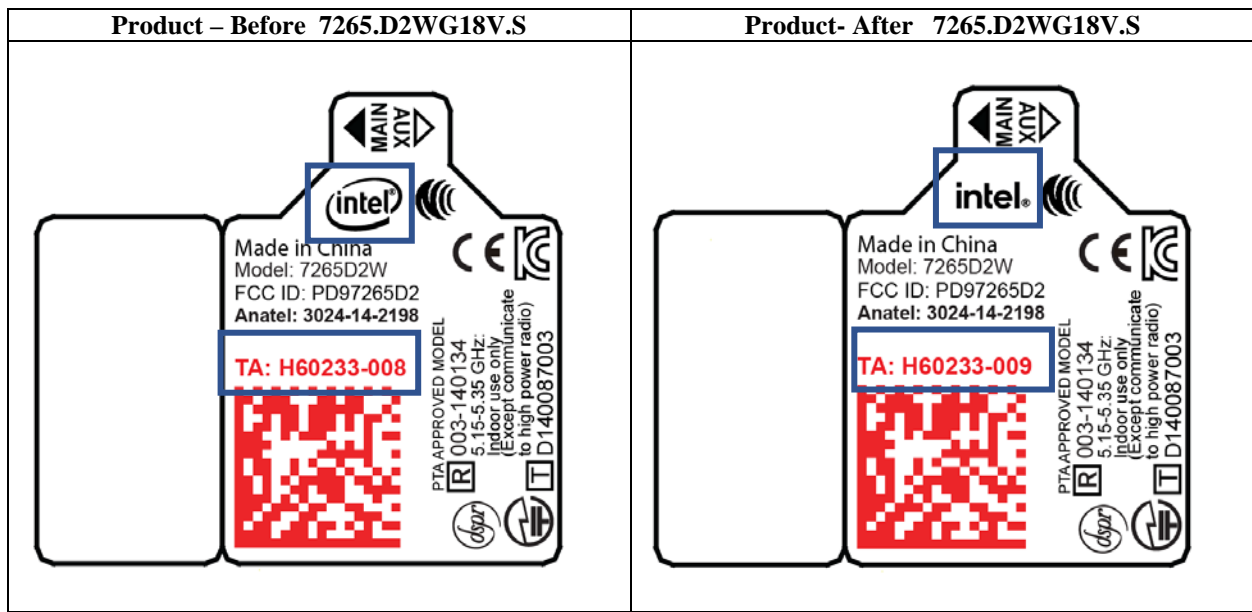

**Disti Label – Before 7265.D2WG18V.S**

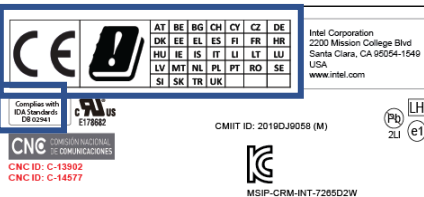
<b>7265.D2WG18V.S</b> VERSION #: H60233-008 MADE IN CHINA WITH PARTIAL FOREIGN CONTENT CARTON #: VVXXXXXXXXXX	QTY: 100 MM#: XXXXXX PACK DATE: DD MMM YY PACKED BY: XXXXXX BATCH #: CCVVYMDRSS	1 88334 00140 2 9 310779 300005	Intel® Dual Band Wireless-AC 7265 (Model : 7265D2W) PKG ID (3S) VVVVMMMMDDDD####PPPPPP100 T P/N: GDM48000206	 Intel Corporation 2200 Mission College Blvd Santa Clara, CA 95054-1549 USA www.intel.com CMIIT ID: 2019DJ0058 (M) MSIP-CRM-INT-7265D2W
			D P/N: P P P P P P    REV AX X    HP P/N: XXXXXX-XXX    REV: XX Vendor ID   Loc Id    Mfg Id    L P/N: XXXXXXXXXXXX VVVVVLLLLL    M M M M M    EC: XXXXXX	

**Disti Label – After 7265.D2WG18V.S**

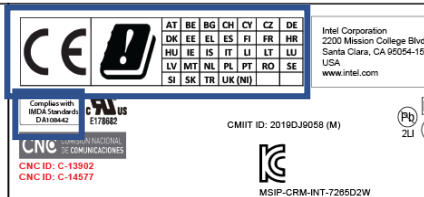
<b>7265.D2WG18V.S</b> VERSION #: H60233-008 MADE IN CHINA WITH PARTIAL FOREIGN CONTENT CARTON #: VVXXXXXXXXXX	QTY: 100 MM#: XXXXXX PACK DATE: DD MMM YY PACKED BY: XXXXXX BATCH #: CCVVYMDRSS	1 88334 00140 2 9 310779 300005	Intel® Dual Band Wireless-AC 7265 (Model : 7265D2W) PKG ID (3S) VVVVMMMMDDDD####PPPPPP100 T P/N: GDM48000206	 Intel Corporation 2200 Mission College Blvd Santa Clara, CA 95054-1549 USA www.intel.com CMIIT ID: 2019DJ0058 (M) MSIP-CRM-INT-7265D2W
			D P/N: P P P P P P    REV AX X    HP P/N: XXXXXX-XXX    REV: XX Vendor ID   Loc Id    Mfg Id    L P/N: XXXXXXXXXXXX VVVVVLLLLL    M M M M M    EC: XXXXXX	



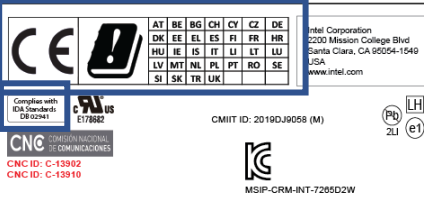

**Disti Label – Before 7265.D2WG.W**

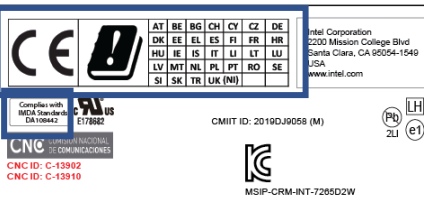
<b>7265.D2WG.W</b> VERSION #: H59008-011 MADE IN CHINA WITH PARTIAL FOREIGN CONTENT CARTON #: VVXXXXXXXXXX	QTY: 100 MM#: XXXXXX PACK DATE: DD MMM YY PACKED BY: XXXXXX BATCH #: CCVVYMDRSS	1 88334 00140 2 9 310779 300005	Intel® Dual Band Wireless-AC 7265 (Model : 7265.D2WG.W) PKG ID (3S) VVVVMMMMDDDD####PPPPPP100 T P/N: GTTTTTTTTTT	 Intel Corporation 2200 Mission College Blvd Santa Clara, CA 95054-1549 USA www.intel.com CMIIT ID: 2019DJ0058 (M) MSIP-CRM-INT-7265D2W
			D P/N: P P P P P P    REV AX X    HP P/N: 810316-001    REV: 0F Vendor ID   Loc Id    Mfg Id    L P/N: SW10A11619 VVVVVLLLLL    M M M M M    EC: 832609	

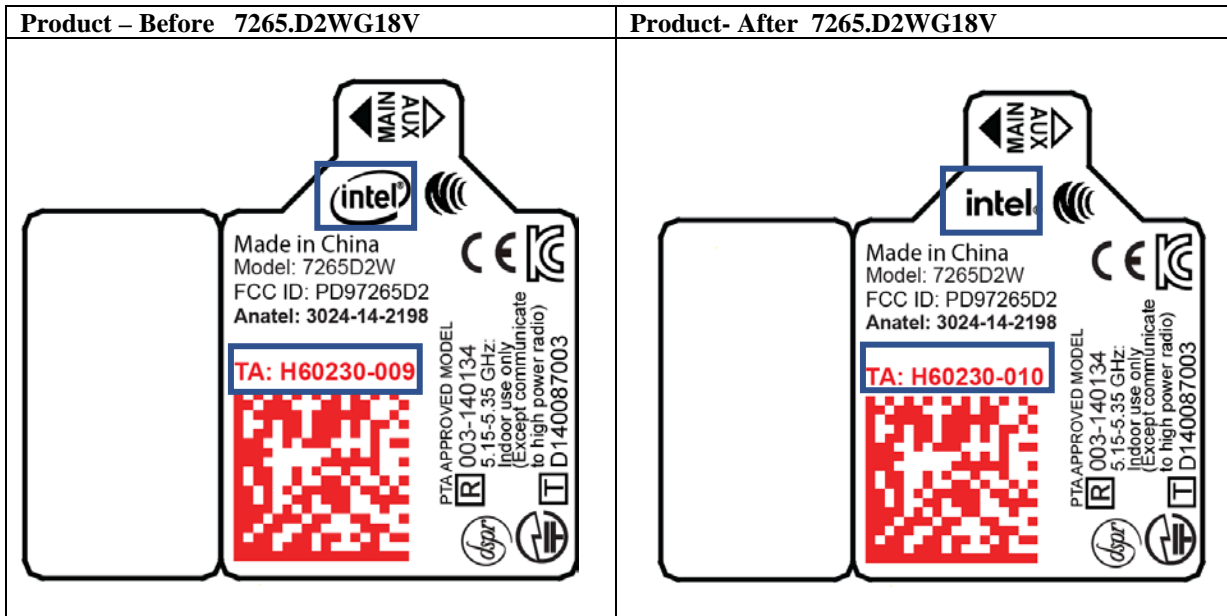
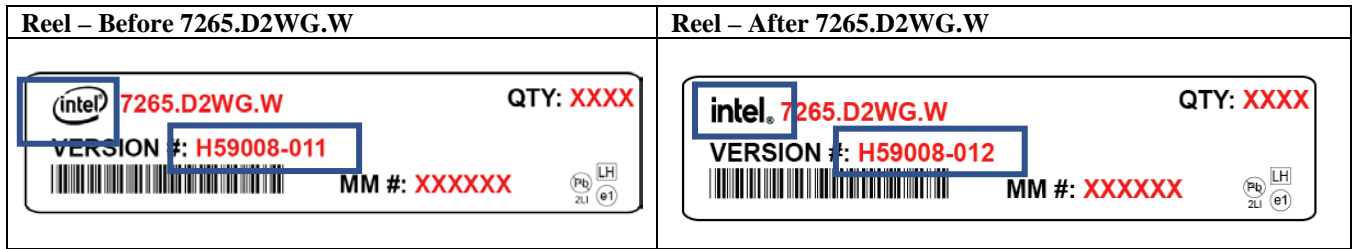
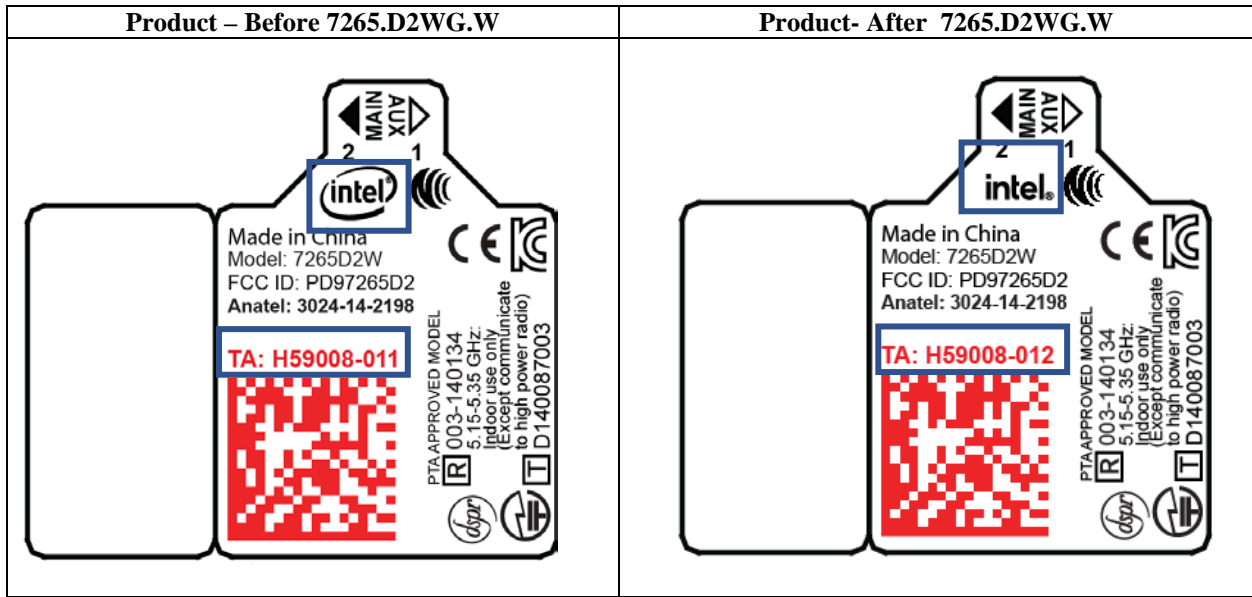
**Disti Label – After 7265.D2WG.W**

<b>7265.D2WG.W</b> VERSION #: H59008-012 MADE IN CHINA WITH PARTIAL FOREIGN CONTENT CARTON #: VVXXXXXXXXXX	QTY: 100 MM#: XXXXXX PACK DATE: DD MMM YY PACKED BY: XXXXXX BATCH #: CCVVYMDRSS	1 88334 00140 2 9 310779 300005	Intel® Dual Band Wireless-AC 7265 (Model : 7265.D2WG.W) PKG ID (3S) VVVVMMMMDDDD####PPPPPP100 T P/N: GTTTTTTTTTT	 Intel Corporation 2200 Mission College Blvd Santa Clara, CA 95054-1549 USA www.intel.com CMIIT ID: 2019DJ0058 (M) MSIP-CRM-INT-7265D2W
			D P/N: P P P P P P    REV AX X    HP P/N: 810316-001    REV: 0F Vendor ID   Loc Id    Mfg Id    L P/N: SW10A11619 VVVVVLLLLL    M M M M M    EC: 832609	

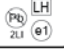

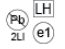
<b>Reel – Before 7265.D2WG18V</b>	<b>Reel – After 7265.D2WG18V</b>
 <b>7265.D2WG18V</b> <b>QTY: XXXX</b> <b>VERSION #: H60230-009</b>  <b>MM #: XXXXXX</b> 	 <b>7265.D2WG18V</b> <b>QTY: XXXX</b> <b>VERSION #: H60230-010</b>  <b>MM #: XXXXXX</b> 

<b>Disti Label – Before 7265.D2WG18V</b>			
<b>7265.D2WG18V</b>  <b>VERSION #: H60230-009</b>  <b>MADE IN CHINA WITH PARTIAL FOREIGN CONTENT</b>  <b>CARTON #: VVXXXXXXXX</b>	<b>QTY: 100</b> <b>MM#: XXXXXX</b>  <b>PACK DATE: DD MMM YY</b> <b>PACKED BY: XXXXXX</b> <b>BATCH #: CCVVYMDRSS</b> 	 1 88334 00140 2  9 310779 300005	<b>Intel® Dual Band Wireless-AC 7265 (Model : 7265D2W)</b> <b>PKG ID (3S) VVVVMMMMDDDD####PPPPPP100</b>  <b>T P/N: GTTTTTTTTTT</b> <b>D P/N: P P P P P P    REV AX X    HP P/N: XXXXX-XXX    REV: XX</b>   <b>PACKAGE WEIGHT: X.X LBS</b> <b>Vendor ID   Loc Id    Mfg Id    L P/N: SW10M73248</b>    <b>EC: 1854498</b>
<b>Disti Label – After 7265.D2WG18V</b>			
<b>7265.D2WG18V</b>  <b>VERSION #: H60230-010</b>  <b>MADE IN CHINA WITH PARTIAL FOREIGN CONTENT</b>  <b>CARTON #: VVXXXXXXXX</b>	<b>QTY: 100</b> <b>MM#: XXXXXX</b>  <b>PACK DATE: DD MMM YY</b> <b>PACKED BY: XXXXXX</b> <b>BATCH #: CCVVYMDRSS</b> 	 1 88334 00140 2  9 310779 300005	<b>Intel® Dual Band Wireless-AC 7265 (Model : 7265D2W)</b> <b>PKG ID (3S) VVVVMMMMDDDD####PPPPPP100</b>  <b>T P/N: GTTTTTTTTTT</b> <b>D P/N: P P P P P P    REV AX X    HP P/N: XXXXX-XXX    REV: XX</b>   <b>PACKAGE WEIGHT: X.X LBS</b> <b>Vendor ID   Loc Id    Mfg Id    L P/N: SW10M73248</b>    <b>EC: 1854498</b>

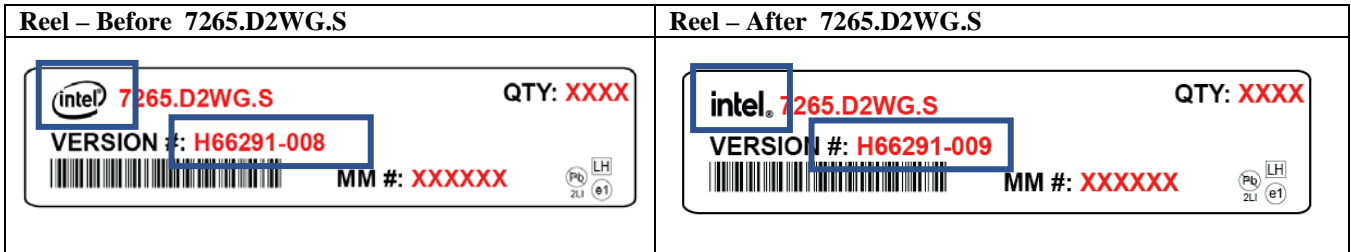
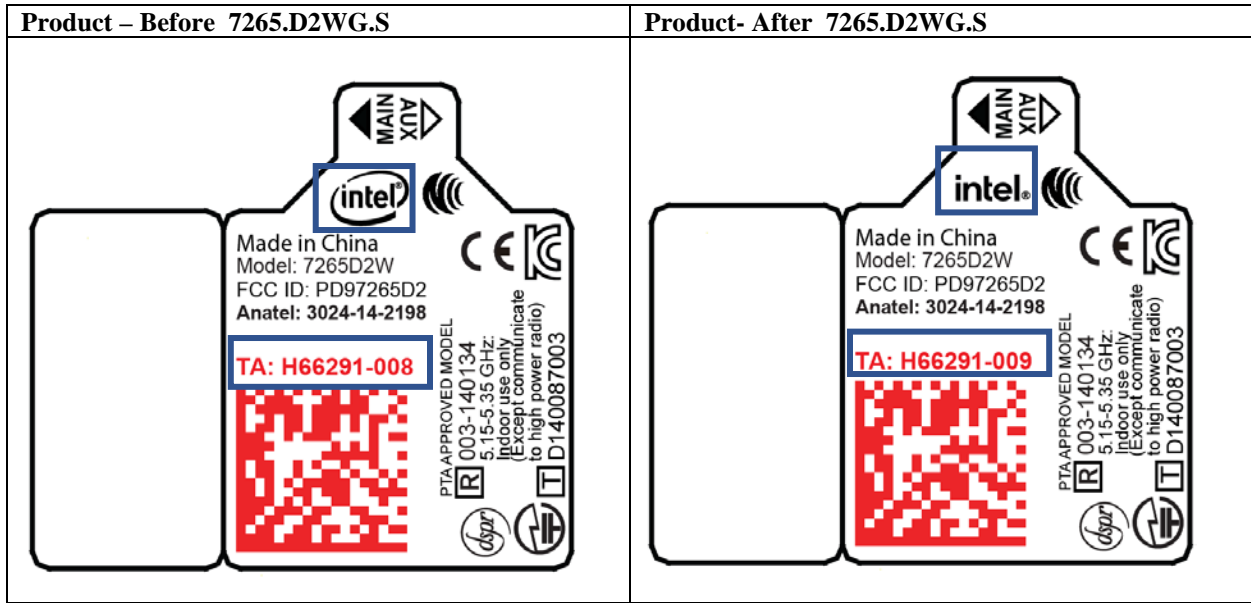

**Disti Label – Before 7265.D2WG.S**

<p><b>7265.D2WG.S</b></p> <p>VERSION #: <b>H66291-008</b></p> <p>MADE IN CHINA WITH PARTIAL FOREIGN CONTENT CARTON #: <b>VVXXXXXXXX</b></p>	<p><b>MM#: XXXXXX</b></p> <p>PACK DATE: <b>DD MMM YY</b> PACKED BY: <b>XXXXXX</b></p> <p>BATCH #: <b>CCVYMDRSS</b></p>	<p><b>QTY: 100</b></p> <p>88334 00140 2</p> <p>9 310779 300005</p>	<p>Intel® Dual Band Wireless-AC 7265 (Model : 7265.D2WG.S)</p> <p>PKG ID (3S) <b>VVVVMMMMDDDD####PPPPPP100</b></p> <p>T P/N: GTTTTTTTTTT</p>	<table border="1"> <tr><td>AT</td><td>BE</td><td>BG</td><td>CH</td><td>CY</td><td>CZ</td><td>DE</td></tr> <tr><td>DK</td><td>EE</td><td>EL</td><td>ES</td><td>FI</td><td>FR</td><td>HR</td></tr> <tr><td>HU</td><td>IE</td><td>IS</td><td>IT</td><td>LI</td><td>LT</td><td>LU</td></tr> <tr><td>LV</td><td>MT</td><td>NL</td><td>PL</td><td>PT</td><td>RO</td><td>SE</td></tr> <tr><td>SI</td><td>SK</td><td>TR</td><td>UK</td><td></td><td></td><td></td></tr> </table> <p>Intel Corporation 2200 Mission College Blvd Santa Clara, CA 95054-1549 USA www.intel.com</p> <p>Complies with IEC Standard DA 10842 E17862</p> <p>CNC COMERCIAL DE COMUNICACIONES CNC ID: C-13902 CNC ID: C-14577</p> <p>CMIT ID: 2019DJ0058 (M)</p> <p>MSIP-CRM-INT-7265D2W</p>	AT	BE	BG	CH	CY	CZ	DE	DK	EE	EL	ES	FI	FR	HR	HU	IE	IS	IT	LI	LT	LU	LV	MT	NL	PL	PT	RO	SE	SI	SK	TR	UK			
			AT		BE	BG	CH	CY	CZ	DE																													
DK	EE	EL	ES	FI	FR	HR																																	
HU	IE	IS	IT	LI	LT	LU																																	
LV	MT	NL	PL	PT	RO	SE																																	
SI	SK	TR	UK																																				
<p>D P/N: <b>PPPPPP</b>    REV <b>AXX</b>    HP P/N: <b>XXXXXX-XXX</b>    REV: <b>XX</b></p> <p>Vendor ID   Loc Id    Mfg Id    L P/N: <b>XXXXXXXXXX</b></p> <p><b>VVVVVLLLLL</b>    <b>MMMMM</b>    <b>XXXXXXXXXX</b></p> <p>EC: <b>XXXXXX</b></p>																																							

**Disti Label – After 7265.D2WG.S**

<p><b>7265.D2WG.S</b></p> <p>VERSION #: <b>H66291-009</b></p> <p>MADE IN CHINA WITH PARTIAL FOREIGN CONTENT CARTON #: <b>VVXXXXXXXX</b></p>	<p><b>MM#: XXXXXX</b></p> <p>PACK DATE: <b>DD MMM YY</b> PACKED BY: <b>XXXXXX</b></p> <p>BATCH #: <b>CCVYMDRSS</b></p>	<p><b>QTY: 100</b></p> <p>88334 00140 2</p> <p>9 310779 300005</p>	<p>Intel® Dual Band Wireless-AC 7265 (Model : 7265.D2WG.S)</p> <p>PKG ID (3S) <b>VVVVMMMMDDDD####PPPPPP100</b></p> <p>T P/N: GTTTTTTTTTT</p>	<table border="1"> <tr><td>AT</td><td>BE</td><td>BG</td><td>CH</td><td>CY</td><td>CZ</td><td>DE</td></tr> <tr><td>DK</td><td>EE</td><td>EL</td><td>ES</td><td>FI</td><td>FR</td><td>HR</td></tr> <tr><td>HU</td><td>IE</td><td>IS</td><td>IT</td><td>LI</td><td>LT</td><td>LU</td></tr> <tr><td>LV</td><td>MT</td><td>NL</td><td>PL</td><td>PT</td><td>RO</td><td>SE</td></tr> <tr><td>SI</td><td>SK</td><td>TR</td><td>UK</td><td>(N)</td><td></td><td></td></tr> </table> <p>Intel Corporation 2200 Mission College Blvd Santa Clara, CA 95054-1549 USA www.intel.com</p> <p>Complies with IEC Standard DA 10842 E17862</p> <p>CNC COMERCIAL DE COMUNICACIONES CNC ID: C-13902 CNC ID: C-14577</p> <p>CMIT ID: 2019DJ0058 (M)</p> <p>MSIP-CRM-INT-7265D2W</p>	AT	BE	BG	CH	CY	CZ	DE	DK	EE	EL	ES	FI	FR	HR	HU	IE	IS	IT	LI	LT	LU	LV	MT	NL	PL	PT	RO	SE	SI	SK	TR	UK	(N)		
			AT		BE	BG	CH	CY	CZ	DE																													
DK	EE	EL	ES	FI	FR	HR																																	
HU	IE	IS	IT	LI	LT	LU																																	
LV	MT	NL	PL	PT	RO	SE																																	
SI	SK	TR	UK	(N)																																			
<p>D P/N: <b>PPPPPP</b>    REV <b>AXX</b>    HP P/N: <b>XXXXXX-XXX</b>    REV: <b>XX</b></p> <p>Vendor ID   Loc Id    Mfg Id    L P/N: <b>XXXXXXXXXX</b></p> <p><b>VVVVVLLLLL</b>    <b>MMMMM</b>    <b>XXXXXXXXXX</b></p> <p>EC: <b>XXXXXX</b></p>																																							

**Disti Label - Before 7265.D2WG.I**

<p><b>7265.D2WG.I</b></p> <p>VERSION #: <b>H92392-007</b></p> <p>MADE IN CHINA WITH PARTIAL FOREIGN CONTENT CARTON #: <b>VVXXXXXXXX</b></p>	<p><b>MM#: XXXXXX</b></p> <p>PACK DATE: <b>DD MMM YY</b> PACKED BY: <b>XXXXXX</b></p> <p>BATCH #: <b>CCVYMDRSS</b></p>	<p><b>QTY: 100</b></p> <p>88334 00140 2</p> <p>9 310779 300005</p>	<p>Intel® Dual Band Wireless-AC 7265 (Model: 7265D2W)</p> <p>PKG ID (3S) <b>VVVVMMMMDDDD####PPPPPP100</b></p> <p>T P/N: GTTTTTTTTTT</p>	<table border="1"> <tr><td>AT</td><td>BE</td><td>BG</td><td>CH</td><td>CY</td><td>CZ</td><td>DE</td></tr> <tr><td>DK</td><td>EE</td><td>EL</td><td>ES</td><td>FI</td><td>FR</td><td>HR</td></tr> <tr><td>HU</td><td>IE</td><td>IS</td><td>IT</td><td>LI</td><td>LT</td><td>LU</td></tr> <tr><td>LV</td><td>MT</td><td>NL</td><td>PL</td><td>PT</td><td>RO</td><td>SE</td></tr> <tr><td>SI</td><td>SK</td><td>TR</td><td>UK</td><td>(W)</td><td></td><td></td></tr> </table> <p>Intel Corporation 2200 Mission College Blvd Santa Clara, CA 95054-1549 USA www.intel.com</p> <p>Complies with IEC Standard DA 10842 E17862</p> <p>CNC COMERCIAL DE COMUNICACIONES CNC ID: C-13902 CNC ID: C-14577</p> <p>CMIT ID: 2019DJ0058 (M)</p> <p>MSIP-CRM-INT-7265D2W</p>	AT	BE	BG	CH	CY	CZ	DE	DK	EE	EL	ES	FI	FR	HR	HU	IE	IS	IT	LI	LT	LU	LV	MT	NL	PL	PT	RO	SE	SI	SK	TR	UK	(W)		
			AT		BE	BG	CH	CY	CZ	DE																													
DK	EE	EL	ES	FI	FR	HR																																	
HU	IE	IS	IT	LI	LT	LU																																	
LV	MT	NL	PL	PT	RO	SE																																	
SI	SK	TR	UK	(W)																																			
<p>D P/N: <b>PPPPPP</b>    REV <b>AXX</b>    HP P/N: <b>XXXXXX-XXX</b>    REV: <b>XX</b></p> <p>Vendor ID   Loc Id    Mfg Id    L P/N: <b>XXXXXXXXXX</b></p> <p><b>VVVVVLLLLL</b>    <b>MMMMM</b>    <b>XXXXXXXXXX</b></p> <p>EC: <b>XXXXXX</b></p>																																							

**Disti Label - After 7265.D2WG.I**

<p><b>7265.D2WG.I</b></p> <p>VERSION #: <b>H92392-008</b></p> <p>MADE IN CHINA WITH PARTIAL FOREIGN CONTENT CARTON #: <b>VVXXXXXXXX</b></p>	<p><b>MM#: XXXXXX</b></p> <p>PACK DATE: <b>DD MMM YY</b> PACKED BY: <b>XXXXXX</b></p> <p>BATCH #: <b>CCVYMDRSS</b></p>	<p><b>QTY: 100</b></p> <p>88334 00140 2</p> <p>9 310779 300005</p>	<p>Intel® Dual Band Wireless-AC 7265 (Model: 7265D2W)</p> <p>PKG ID (3S) <b>VVVVMMMMDDDD####PPPPPP100</b></p> <p>T P/N: GTTTTTTTTTT</p>	<table border="1"> <tr><td>AT</td><td>BE</td><td>BG</td><td>CH</td><td>CY</td><td>CZ</td><td>DE</td></tr> <tr><td>DK</td><td>EE</td><td>EL</td><td>ES</td><td>FI</td><td>FR</td><td>HR</td></tr> <tr><td>HU</td><td>IE</td><td>IS</td><td>IT</td><td>LI</td><td>LT</td><td>LU</td></tr> <tr><td>LV</td><td>MT</td><td>NL</td><td>PL</td><td>PT</td><td>RO</td><td>SE</td></tr> <tr><td>SI</td><td>SK</td><td>TR</td><td>UK</td><td>(W)</td><td></td><td></td></tr> </table> <p>Intel Corporation 2200 Mission College Blvd Santa Clara, CA 95054-1549 USA www.intel.com</p> <p>Complies with IEC Standard DA 10842 E17862</p> <p>CNC COMERCIAL DE COMUNICACIONES CNC ID: C-13902 CNC ID: C-14577</p> <p>CMIT ID: 2019DJ0058 (M)</p> <p>MSIP-CRM-INT-7265D2W</p>	AT	BE	BG	CH	CY	CZ	DE	DK	EE	EL	ES	FI	FR	HR	HU	IE	IS	IT	LI	LT	LU	LV	MT	NL	PL	PT	RO	SE	SI	SK	TR	UK	(W)		
			AT		BE	BG	CH	CY	CZ	DE																													
DK	EE	EL	ES	FI	FR	HR																																	
HU	IE	IS	IT	LI	LT	LU																																	
LV	MT	NL	PL	PT	RO	SE																																	
SI	SK	TR	UK	(W)																																			
<p>D P/N: <b>PPPPPP</b>    REV <b>AXX</b>    HP P/N: <b>XXXXXX-XXX</b>    REV: <b>XX</b></p> <p>Vendor ID   Loc Id    Mfg Id    L P/N: <b>XXXXXXXXXX</b></p> <p><b>VVVVVLLLLL</b>    <b>MMMMM</b>    <b>XXXXXXXXXX</b></p> <p>EC: <b>XXXXXX</b></p>																																							

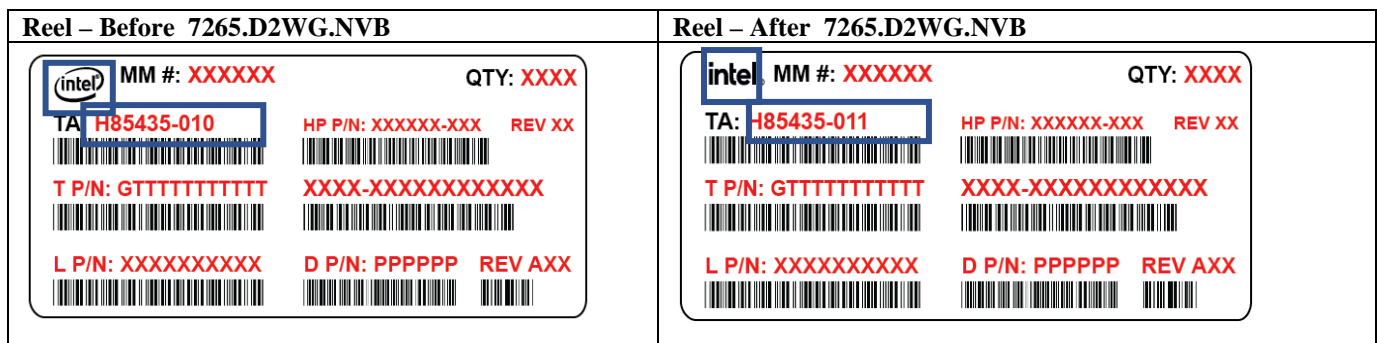
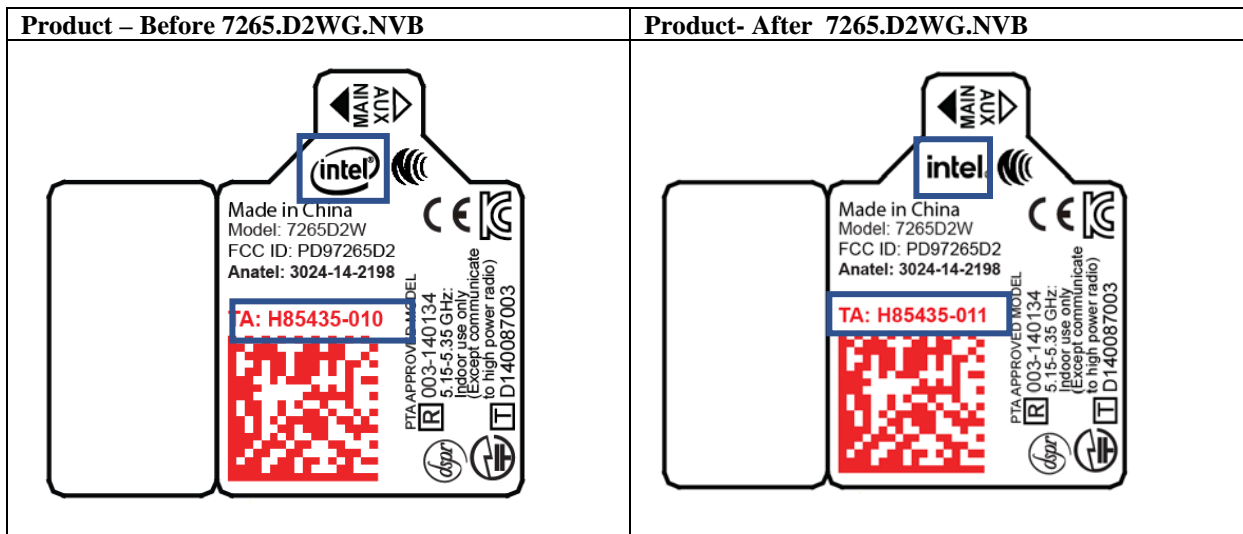
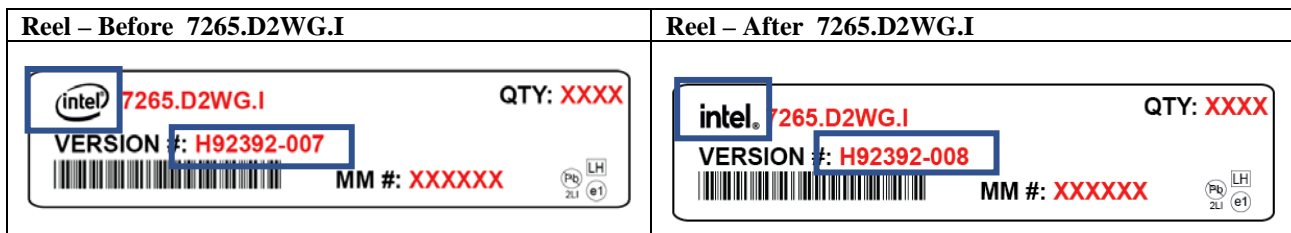
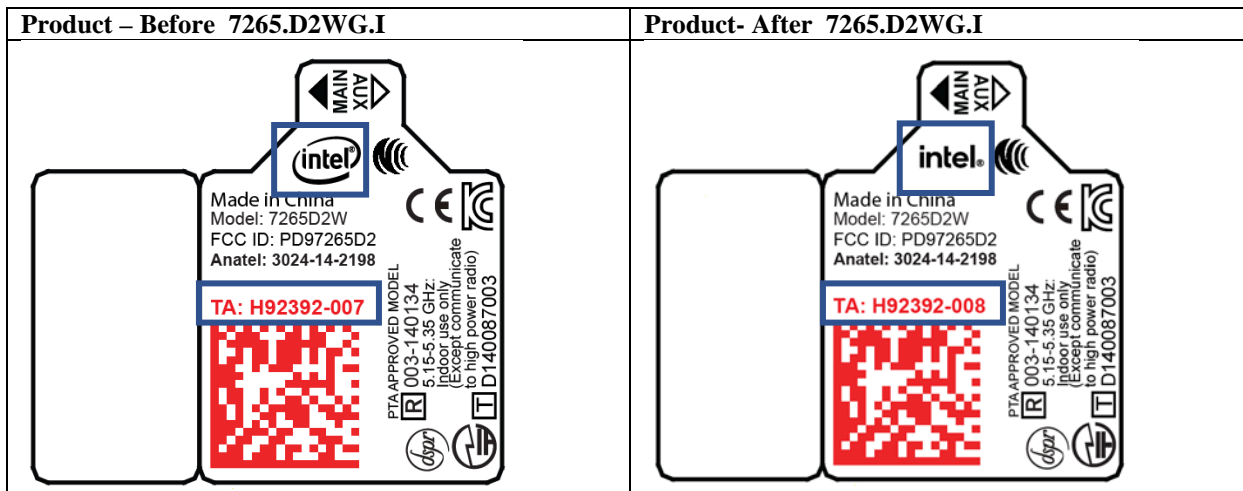



## Customer Impact of Change and Recommended Action:

The label and packaging changes to the products do not affect functionality. Intel anticipates no impact to customers.

Intel will attempt to deplete pre-conversion material before shipping post-conversion material but there is a possibility of Intel shipping mixed inventory. Therefore, customers will need to manage and migrate to the post-conversion material as soon as possible.

Milestone dates are estimates and subject to change based on business and operational conditions.

Please contact your local Intel Field Sales Rep if you have any further questions about these changes

## Products Affected/Intel Ordering Codes:

Marketing Name	Product Code	MM#	Pre Change TA	Post Change TA
Intel® Dual Band Wireless-AC 7265, 2x2 AC + BT, 1.8V No vPro® M.2, Low Power	7265.D2WG18V.S	934460	H60233-008	H60233-009
Intel® Dual Band Wireless-AC 7265, 2x2 AC + BT, vPro® M.2	7265.D2WG.W	939403	H59008-011	H59008-012
Intel® Dual Band Wireless-AC 7265, 2x2 AC + BT, 1.8V vPro® M.2	7265.D2WG18V	934449	H60230-009	H60230-010
Intel® Dual Band Wireless-AC 7265, 2x2 AC + BT, vPro® M.2, Low Power	7265.D2WG.S	934470	H66291-008	H66291-009
Intel® Dual Band Wireless-AC 7265, 2x2 AC + BT, vPro® M.2, (Indonesia)	7265.D2WG.I	936899	H92392-007	H92392-008
Intel® Dual Band Wireless-AC 7265, 2x2 AC + BT, M.2, No vPro®	7265.D2WG.NVB	944431	H85435-010	H85435-011

## PCN Revision History:

**Date of Revision:**

May 12, 2021

**Revision Number:**

00

**Reason:**

Originally Published PCN



# Product Change Notification

## 118253-00

**INFORMATION IN THIS DOCUMENT IS PROVIDED IN CONNECTION WITH INTEL PRODUCTS. NO LICENSE, EXPRESS OR IMPLIED, BY ESTOPPEL OR OTHERWISE, TO ANY INTELLECTUAL PROPERTY RIGHTS IS GRANTED BY THIS DOCUMENT. EXCEPT AS PROVIDED IN INTEL'S TERMS AND CONDITIONS OF SALE FOR SUCH PRODUCTS, INTEL ASSUMES NO LIABILITY WHATSOEVER AND INTEL DISCLAIMS ANY EXPRESS OR IMPLIED WARRANTY, RELATING TO SALE AND/OR USE OF INTEL PRODUCTS INCLUDING LIABILITY OR WARRANTIES RELATING TO FITNESS FOR A PARTICULAR PURPOSE, MERCHANTABILITY, OR INFRINGEMENT OF ANY PATENT, COPYRIGHT OR OTHER INTELLECTUAL PROPERTY RIGHT.**

A "Mission Critical Application" is any application in which failure of the Intel Product could result, directly or indirectly, in personal injury or death. SHOULD YOU PURCHASE OR USE INTEL'S PRODUCTS FOR ANY SUCH MISSION CRITICAL APPLICATION, YOU SHALL INDEMNIFY AND HOLD INTEL AND ITS SUBSIDIARIES, SUBCONTRACTORS AND AFFILIATES, AND THE DIRECTORS, OFFICERS, AND EMPLOYEES OF EACH, HARMLESS AGAINST ALL CLAIMS COSTS, DAMAGES, AND EXPENSES AND REASONABLE ATTORNEYS' FEES ARISING OUT OF, DIRECTLY OR INDIRECTLY, ANY CLAIM OF PRODUCT LIABILITY, PERSONAL INJURY, OR DEATH ARISING IN ANY WAY OUT OF SUCH MISSION CRITICAL APPLICATION, WHETHER OR NOT INTEL OR ITS SUBCONTRACTOR WAS NEGLIGENT IN THE DESIGN, MANUFACTURE, OR WARNING OF THE INTEL PRODUCT OR ANY OF ITS PARTS.

Intel may make changes to specifications and product descriptions at any time, without notice. Designers must not rely on the absence or characteristics of any features or instructions marked "reserved" or "undefined". Intel reserves these for future definition and shall have no responsibility whatsoever for conflicts or incompatibilities arising from future changes to them. The information here is subject to change without notice. Do not finalize a design with this information.

The products described in this document may contain design defects or errors known as errata which may cause the product to deviate from published specifications. Current characterized errata are available on request.

**Should you have any issues with the timeline or content of this change, please contact the Intel Representative(s) for your geographic location listed below. No response from customers will be deemed as acceptance of the change and the change will be implemented pursuant to the key milestones set forth in this attached PCN.**

**Americas Contact:** [asmo.pcn@intel.com](mailto:asmo.pcn@intel.com)

**Asia Pacific/PRC Contact:** [apacgccb@intel.com](mailto:apacgccb@intel.com)

**Europe Email:** [eccb@intel.com](mailto:eccb@intel.com)

**Japan Email:** [jccb.ijkk@intel.com](mailto:jccb.ijkk@intel.com)

Copyright © Intel Corporation 2021. Other names and brands may be claimed as the property of others.

3D XPoint, Axxia, Basis, Basis Peak, BlueMoon, BunnyPeople, Celeron, Centrino, Cilk, Curie, Flexpipe, Intel, the Intel logo, Intel Atom, Intel CoFluent, Intel Core, Intel. Experience What's Inside, the Intel. Experience What's Inside logo, Intel Inside, the Intel Inside logo, Intel Insider, Intel Joule, Intel RealSense, Intel SingleDriver, Intel SpeedStep, Intel Unite, Intel vPro, Intel Xeon Phi, Intel XScale, InTru, the InTru logo, the InTru Inside logo, InTru soundmark, Iris, Itanium, MCS, MMX, Optane, Ostro, Pali, Pentium, picoArray, Picochip, picoXcell, Puma, Quark, SMARTi, Soletta, Sound Mark, StarPro, Stay With It, the Engineering Stay With It logo, StreamSight, Tarari, The Journey Inside, Thunderbolt, the Thunderbolt logo, Transcede, True Key, Ultrabook, VTune, Xeon, X-GOLD, XMM, X-PMU and XPOSYS are trademarks of Intel Corporation or its subsidiaries in the U.S. and/or other countries.

Microsoft, Windows, and the Windows logo are trademarks, or registered trademarks of Microsoft Corporation in the United States and/or other countries. Java is a registered trademark of Oracle and/or its affiliates. Bluetooth is a trademark owned by its proprietor and used by Intel Corporation under license. Intel Corporation uses the Palm OS\* Ready mark under license from Palm, Inc. OpenCL and the OpenCL logo are trademarks of Apple Inc. used by permission by Khronos.

Learn how to use Intel Trademarks and Brands correctly at <http://www.intel.com/intel/legal/tmusage2.htm>.